

DC 5920PL SERIES FAN

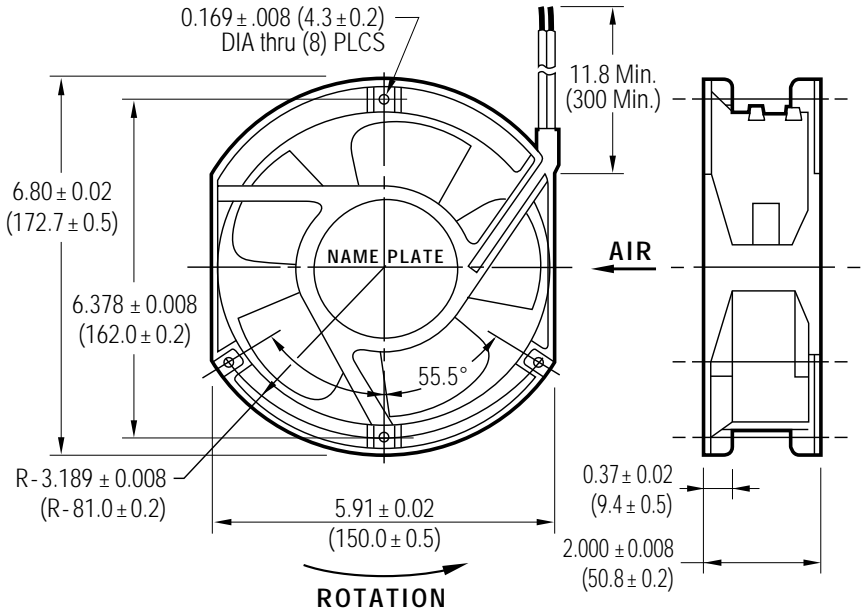

FEATURES:

- Size 5.9 in X 6.8 in X 2.0 in (150mm X 173mm X 51mm)
- Airflow 180 - 240 CFM
- Weight 29 oz (830g)
- Noise 50-58 dBA
- Lead Wire AWG 22, Red/Black, UL1007, CSA TR-64
- Terminal 0.110 in (Optional)
- Impeller UL94V-0 Reinforced plastic
- Venturi Aluminum alloy

† Non-stock item, may be subject to lead time

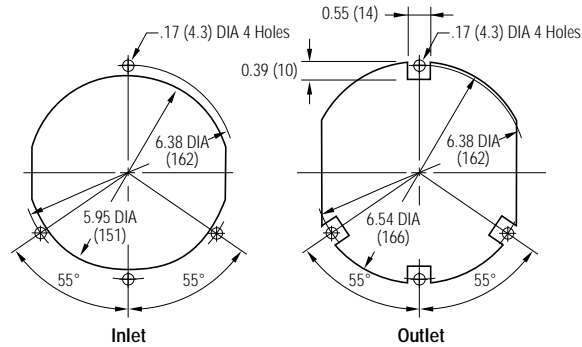

Dimensions are in inches. () are in millimeters

MODEL	VOLTAGE (V)	RANGE (V)	POWER (W)	CURRENT (mA)	SPEED (RPM)	NOISE (dBA)	NOISE NPEL (BELS)				PRESSURE (in H ₂ O)	AIRFLOW CFM	MODEL	VOLTAGE (V)	RANGE (V)	POWER (W)	CURRENT (mA)	SPEED (RPM)	NOISE (dBA)	NOISE NPEL (BELS)				PRESSURE (in H ₂ O)	AIRFLOW CFM
							100%	80%	60%	20%										100%	80%	60%	20%		
5920PL-04W-B10-D00	12	6-14	10.1	840	250	52	6.76	6.54	6.38	6.56	0.37	180	B30-D00	24	12-28	15.1	630	3150	58	7.23	7.04	6.83	7.08	0.56	226
B20-D00†	12	6-14	13.2	1100	2850	55	7.02	6.81	6.69	6.89	0.47	200	B40-D00	24	12-28	17.5	730	3350	60	7.32	7.07	6.85	7.22	0.62	240
B30-D00	12	6-14	16.8	1400	3150	58	7.23	7.04	6.83	7.08	0.56	226	5920PL-07W-B10-D00	48	28-56	9.6	200	2550	52	6.67	6.54	6.38	6.56	0.37	180
B40-D00	12	6-14	20.4	1700	3350	60	7.32	7.07	6.85	7.22	0.62	240	B20-D00†	48	28-56	12.0	250	2850	55	7.02	6.81	6.69	6.89	0.47	200
5920PL-05W-B10-D00	24	12-28	9.1	380	2550	52	6.76	6.54	6.38	6.56	0.37	180	B30-D00	48	28-56	14.4	300	3150	58	7.23	7.04	6.83	7.08	0.56	226
B20-D00†	24	12-28	11.5	480	2850	55	7.02	6.81	6.69	6.89	0.47	200	B40-D00	48	28-56	16.3	340	3350	60	7.32	7.07	6.85	7.22	0.62	240

