

Energizer®

RECHARGEABLE LED LIGHT

INSTRUCTIONS PERTAINING TO A RISK OF FIRE, ELECTRIC SHOCK, OR INJURY TO PERSONS IMPORTANT SAFETY INSTRUCTIONS WARNING

When using electric appliances, basic precautions should always be followed, including the following:

Read instructions carefully. To reduce the risk of injury, close supervision is necessary when an appliance is used near children. Risk of electric shock. Do not charge outdoors. Never use with extension cords.

- Do not plug into an outlet if the plug or the outlet is wet.
- The battery is permanently sealed against leakage. Do not open, burn or crush the battery.
- To reduce the risk of electrical shock, do not immerse light in water or other liquid.
- The light is not watertight. Do not place or store appliance where it can be pulled into a tub or sink.
- Use only the charger supplied by the manufacturer to recharge.

OPERATING INSTRUCTIONS

How to Charge

- Before using your light, charge it for 24 hours (normal charge time).
- Flip up prongs (Fig. A), plug into outlet (Fig. B). Red LED indicates charging.
- Light may be plugged into the outlet indefinitely without harm.

USER-MAINTENANCE INSTRUCTIONS

To Remove Battery

- Refer to figures C-D for battery removal. (Recycle the battery).

SAVE THESE INSTRUCTIONS

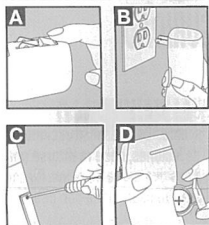

Energizer®

Mfd. for:
Energizer Holdings, Inc.
St. Louis, MO 63141

Light made in China
UPN-121388