

Product Manuals

OPERATOR'S MANUAL

Introduction

Using Your Operator's Manual

Read this entire operator's manual, especially the safety information, before operating.

This manual is an important part of your machine. Keep all manuals in a convenient location so they can be accessed easily.

Use the safety and operating information in the attachment operator's manual, along with the machine operator's manual, to operate and service the attachment safely and correctly.

If your attachment manual has a section called Preparing the Machine, it means that you will have to do something to your tractor or vehicle before you can install the attachment. The Assembly and Installation sections of this manual provide information to assemble and install the attachment to your tractor or vehicle. Use the Service section to make any needed adjustments and routine service to your attachment.

If you have any questions or concerns with the assembly, installation, or operation of this attachment, see your local John Deere dealer or call the John Deere Customer Contact Center at 1-800-537-8233 for assistance.

Warranty information on this John Deere attachment can be found in the warranty that came with your John Deere tractor or vehicle.

Copyright © 1996-2008 Deere & Company. All Rights Reserved.[About Our Site](#) | [Privacy](#) | [Legal](#)

[Close Window](#) | [All Manuals](#)

Product Manuals

OPERATOR'S MANUAL

Product Identification

Record Identification Numbers

Snowblower For John Deere L100 Series, G100 Series and 100 Series.

44-Inch Serial No. (010001 -)

When contacting a John Deere Dealer for information on servicing, always provide the product model and serial number.

Locate the model and serial number for the machine and record the information in the spaces provided below.

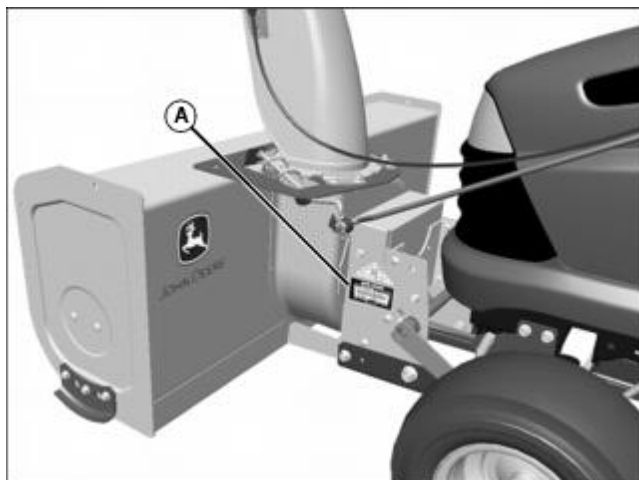

MX37425

DATE OF PURCHASE:

DEALER NAME:

DEALER PHONE:

PRODUCT SERIAL NUMBER (A):

Copyright © 1996-2008 Deere & Company. All Rights Reserved. [About Our Site](#) | [Privacy](#) | [Legal](#)

Product Manuals

OPERATOR'S MANUAL

Safety

Read Safety in Machine Operator's Manual

Read the general safety operating precautions in your machine operator's manual for additional safety information.

Safe Operation Practices for Ride On Snow Throwers

This snowthrower is capable of amputating hands and feet and throwing objects. Failure to observe the following safety instructions could result in serious injury.

Training

- Read, understand and follow all instructions on the machine and in the manuals before operating this unit. Be thoroughly familiar with the controls and the proper use of the equipment. Know how to stop the unit and disengage the controls quickly.
- Never allow children to operate the equipment. Never allow adults to operate the equipment without proper instruction.
- Keep the area of operation clear of all persons, particularly small children.

Preparation

- Thoroughly inspect the area where the equipment is to be used and remove all doormats, sleds, boards, wires, and other foreign objects.
- Disengage all clutches and shift into neutral before starting the engine.
- Do not operate the equipment without wearing adequate winter garments. Avoid loose fitting clothing that can get caught in moving parts. Wear footwear that will improve footing on slippery surfaces.
- Handle fuel with care; it is highly flammable.
 - a. Use an approved fuel container.
 - b. Never add fuel to a running engine or hot engine.

- c. Fill fuel tank outdoors with extreme care. Never fill fuel tank indoors.
- d. Never fill containers inside a vehicle or on a truck or trailer bed with a plastic liner. Always place containers on the ground, away from your vehicle, before filling.
- e. When practical, remove gas-powered equipment from the truck or trailer and refuel it on the ground. If this is not possible, then refuel such equipment on a trailer with a portable container, rather than from a gasoline dispenser nozzle.
- f. Keep the nozzle in contact with the rim of the fuel tank or container opening at all times, until refueling is complete. Do not use a nozzle lock-open device.
- g. Replace gasoline cap securely and wipe up spilled fuel.
- h. If fuel is spilled on clothing, change clothing immediately.
- Adjust the collector housing height to clear gravel or crushed rock surface.
- Never attempt to make any adjustments while the engine is running (except when specifically recommended by the manufacturer).
- Always wear safety glasses or eye shields during operation or while performing an adjustment or repair to protect eyes from foreign objects that may be thrown from the machine.

Operation

- Do not put hands or feet near or under rotating parts. Keep clear of the discharge opening at all times.
- Exercise extreme caution when operating on or crossing gravel drives, walks, or roads. Stay alert for hidden hazards or traffic.
- After striking a foreign object, stop the engine, remove the spark plug wire, thoroughly inspect the snow thrower for any damage, and repair the damage before restarting and operating the snow thrower.
- If the unit should start to vibrate abnormally, stop the engine and check immediately for the cause.
- Stop the engine whenever you leave the operating position, before unclogging the collector or impeller housing, or discharge guide, and when making any repairs, adjustments or inspections.
- When leaving the machine unattended, disengage the power take-off, lower the attachment, lock the park brake, stop the engine, and remove the

key.

- When cleaning, repairing, or inspecting, make certain the collector or impeller and all moving parts have stopped. Disconnect the spark plug wire and keep the wire away from the plug to prevent accidental starting.
- Do not run the engine indoors, except when starting the engine and for transporting the snow thrower in or out of the building. Open the outside doors; exhaust fumes are dangerous.
- Do not clear snow across the face of slopes, go up and down. Exercise extreme caution when operating on slopes. Do not attempt to clear steep slopes.
- Never operate the snow thrower without proper guards, and other safety protective devices in place.
- Never direct the discharge toward people or areas where property damage can occur. Keep children and others away.
- Do not overload the machine capacity by attempting to clear snow at too fast a rate.
- Never operate the machine at high transport speeds on slippery surfaces. Look behind and use care when backing.
- Do not carry passengers.
- Never direct discharge at bystanders or allow anyone in front of the unit.
- Disengage power to the collector or impeller when the snow thrower is transported or not in use.
- Use only attachments and accessories approved by the manufacturer of the snow thrower (such as wheel weights, counterweights, and cabs).
- Never operate the snow thrower without good visibility or light.

Parking Safely

1. Stop machine on a level surface, not on a slope.
2. Disengage mower blades or any other attachments.
3. Lower attachments to the ground.
4. Lock the park brake.
5. Stop the engine.

6. Remove the key.
7. Wait for engine and all moving parts to stop before you leave the operator's seat.
8. Close fuel shut-off valve, if your machine is equipped.
9. Disconnect the negative battery cable or remove the spark plug wire(s) (for gasoline engines) before servicing the machine.

Clearing a Clogged Discharge Chute

- Hand contact with the rotating impeller inside the discharge chute is the most common cause of injury associated with snowthrowers. Never use your hand to clean out the discharge chute.
- To clear the chute:
 - a. Shut the engine off.
 - b. Wait ten seconds to be sure the impeller blades have stopped rotating.
 - c. always use a clean-out tool, not your hands.

Maintenance and Storage

- Check shear bolts and other bolts at frequent intervals for proper tightness to be sure the equipment is in safe working condition.
- Never store the machine with fuel in the fuel tank inside a building where ignition sources are present such as hot water and space heaters, and clothes dryers. Allow the engine to cool before storing in any enclosure.
- Always refer to operator's manual for important details if the snow thrower is to be stored for an extended period.
- Maintain or replace safety and instruction labels as necessary.
- Run the machine a few minutes after throwing snow to prevent freeze up of the collector or impeller.

Practice Safe Maintenance

- Only qualified, trained adults should service this machine.
- Understand service procedure before doing work. Keep area clean and dry.
- Do not operate the engine in a confined space where dangerous carbon monoxide fumes can collect.

- Never lubricate, service or adjust the machine or attachment while it is moving. Keep safety devices in place and in working condition. Keep hardware tight.
- Keep hands, feet, clothing, jewelry, and long hair away from any moving parts, to prevent them from getting caught.
- Lower any attachment completely to the ground or to an existing attachment mechanical stop before servicing the attachment. Disengage all power and stop the engine. Lock park brake and remove the key. Let machine cool.
- Disconnect battery or remove spark plug wire (for gasoline engines) before making any repairs.
- Before servicing machine or attachment, carefully release pressure from any components with stored energy, such as hydraulic components and springs.
- Release hydraulic pressure by lowering attachment or cutting units to the ground or to a mechanical stop and move hydraulic control levers.
- Securely support any machine or attachment elements that must be raised for service work. Use jack stands or lock service latches to support components when needed.
- Never run engine unless park brake is locked.
- Keep all parts in good condition and properly installed. Fix damage immediately. Replace worn or broken parts. Replace all worn or damaged safety and instruction decals.
- Check all hardware at frequent intervals to be sure the equipment is in safe working condition.
- Do not modify machine or safety devices. Unauthorized modifications to the machine or attachment may impair its function and safety.

Avoid Injury from Moving Parts

Before cleaning, repairing, or inspecting, make certain all moving parts have stopped. Disconnect the tractor spark plug wire or battery to prevent accidental starting.

Do not put hands or feet near or under rotating parts. Keep clear of any discharge area at all times.

Protect your hands when you inspect or unplug the attachment. Wear gloves and use proper tools.

Before you dismount to unplug or adjust attachment:

- Disengage PTO.
- Stop the engine.
- Lock the park brake.
- Remove the key.
- Wait for all moving parts to stop.
- Keep hands, feet and clothing away from attachment when engine is running.

Avoid Injury from Hitting Obstructions

- Raise the attachment when driving between jobs.
- Drive at slow speeds when using the attachment. Be cautious of hidden obstacles.

Copyright © 1996-2008 Deere & Company. All Rights Reserved. [About Our Site](#) | [Privacy](#) | [Legal](#)

Product Manuals

OPERATOR'S MANUAL

Safety Labels

Understanding The Machine Safety Labels



The machine safety labels shown in this section are placed in important areas on your machine to draw attention to potential safety hazards.

On your machine safety labels, the words DANGER, WARNING, and CAUTION are used with this safety-alert symbol. DANGER identifies the most serious hazards.

The operator's manual also explains any potential safety hazards whenever necessary in special safety messages that are identified with the word, CAUTION, and the safety-alert symbol.

WARNING and CAUTION



M144854

TO AVOID INJURY FROM THROWN OBJECTS

- Read operator's manual.
- Keep all shields in place.
- Keep bystanders a safe distance away.

To avoid injury from loss of braking or steering,

- Install ballast per operator's manual.

DANGER



M144853

To avoid injury from rotating auger, keep hands, feet and clothing away.

DANGER



M154693

ROTATING BLADE

- Shut off engine before unclogging discharge chute.

Copyright © 1996-2008 Deere & Company. All Rights Reserved. [About Our Site](#) | [Privacy](#) | [Legal](#)

[Close Window](#) | [All Manuals](#)

Product Manuals

OPERATOR'S MANUAL

Assembly - Identify Parts

Snowblower Parts

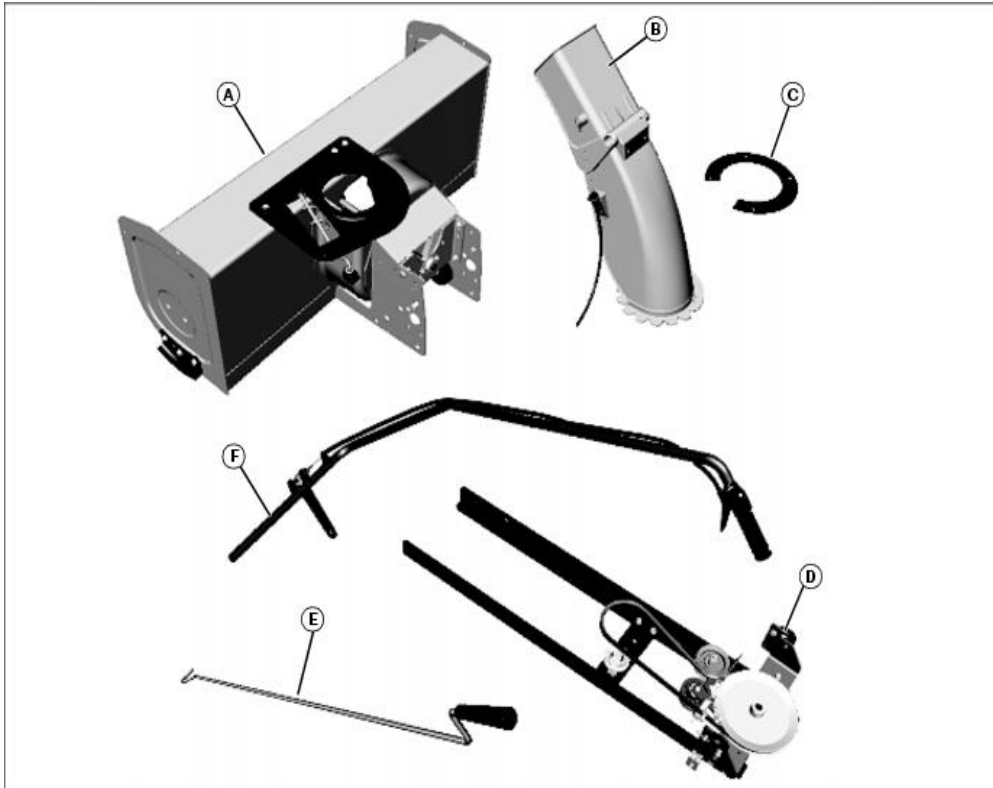

MX37506a

Key	Description	Qty	Key	Description	Qty
A	Housing	1	D	Frame	1
B	Chute Assembly	1	E	Chute Control Handle	1
C	Chute Retaining Bracket	1	F	Lift Lever Assembly	1

Frame Parts

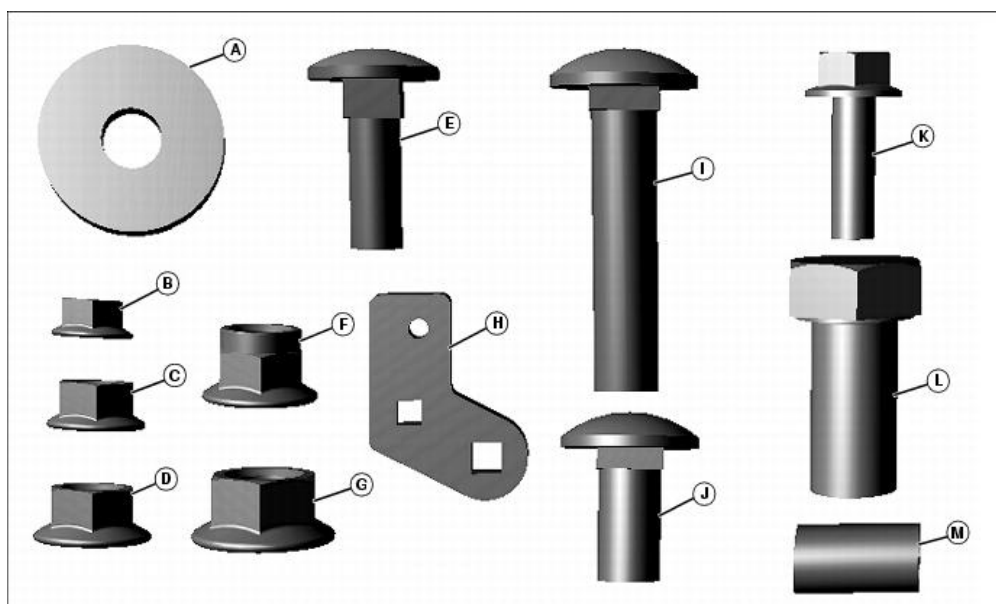

MX38108a

Picture Note: Hardware shown actual size unless noted.

Key	Description	Qty	Key	Description	Qty
A	Washer, M11x34 OD	2	H	Rear Mounting Plate (Not shown actual size)	2
B	Nut, Flange, M8	2	I	Carriage Bolt, M12x55	2
C	Nut, Flange, M10	2	J	Carriage Bolt, M12x25	2
D	Nut, Flange, M12	2	K	Bolt, Flange, M8x25	2
E	Carriage Bolt, M10x30	2	L	Bolt, Hex Head, M16x30	2
F	Locknut, Flange, M12	2	M	Bushing, M12x30 (Not shown actual size)	2
G	Nut, Flange, M16	2			

Lift Parts

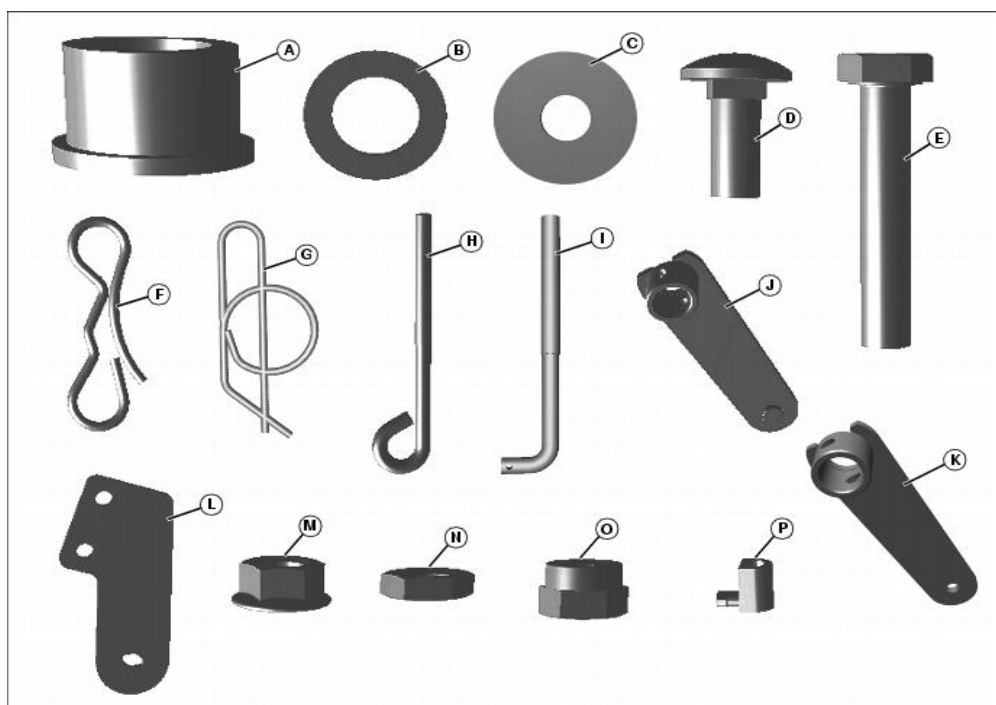

MX39848

Picture Note: Hardware shown actual size unless noted.

Key	Description	Qty	Key	Description	Qty
A	Bearing, 25 mm ID	2	I	Adjustable Lift Rod (SN 020001-) (Not actual size)	2
B	Washer, M17x28 OD (SN -020000)	2	J	Lift Arm (SN 010001-020000) (Not actual size)	2
C	Washer, M10x30 OD (SN 020001-)	2	K	Lift Arm (SN 020001-) (Not actual size)	1
D	Carriage Bolt, M10x25	4	L	Front Mounting Plate (Not actual size)	2
E	Bolt, M10x55	1	M	Nut, Flange, M10	4
F	Spring Locking Clip (SN -020000) (Not actual size)	2	N	Nut, M10	2
G	Cotter Pin, Locking (SN 020001-) (Not actual size)	2	O	Locknut, M10	3
	Adjustable Lift Rod (SN			Adjustable Lift Link	

H	-020000) (Not actual size)	2	P	(Not actual size)	2
---	----------------------------	---	---	-------------------	---

Chute Control Parts

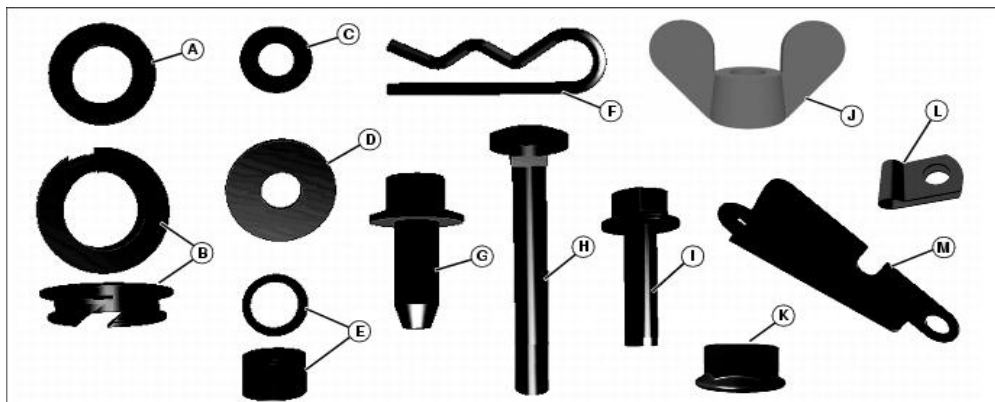

MX38105b

Picture Note: Hardware shown actual size unless noted.

Key	Description	Qty	Key	Description	Qty
A	Washer, M10.5	1	H	Carriage Bolt, M6x45	1
B	Bearing, Split, 13.4 mm	1	I	Bolt, M6x16	1
C	Lockwasher, Serrated, M6	1	J	Wingnut, M6	1
D	Washer, M6.4	1	K	Nut, Flange M6	1
E	Bushing, 8.25 mm ID	4	L	Clamp	1
F	Spring Locking Pin, 2.5 mm	1	M	Chute Control Bracket (Not shown actual size)	1
G	Screw, Self-Tapping, M8x20	4			

Drive Parts

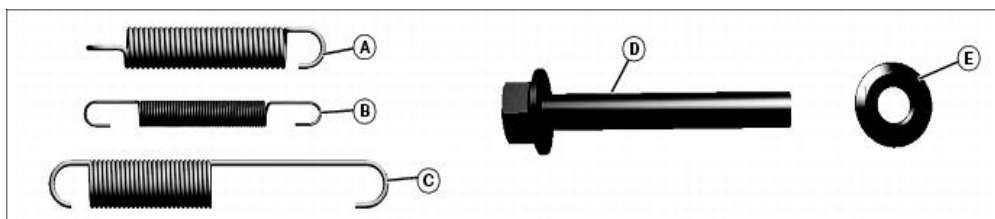

MX38107a

Picture Note: Hardware shown actual size unless noted.

Key	Description	Qty	Key	Description	Qty
A	Spring, Secondary Tensioning (Not shown actual size)	1	D	Bolt, M6x45	2
B	Spring, Primary Tensioning, Manual Mower Engagement (Not shown actual size)	1	E	Nut, Flange, M6	4
C	Spring, Primary Tensioning, Electric Mower Engagement (Not shown actual size)	1			

Copyright © 1996-2008 Deere & Company. All Rights Reserved.[About Our Site](#) | [Privacy](#) | [Legal](#)

Product Manuals

OPERATOR'S MANUAL

Assembly

What You Need to Install this Attachment

Time Needed and Skills Required

- Assembly for this attachment should take the average homeowner with minimal technical skills an average of two hours.

Tools Required

- Metric socket wrench set and open end wrench
- Adjustable wrench

Assemble Frame to Housing

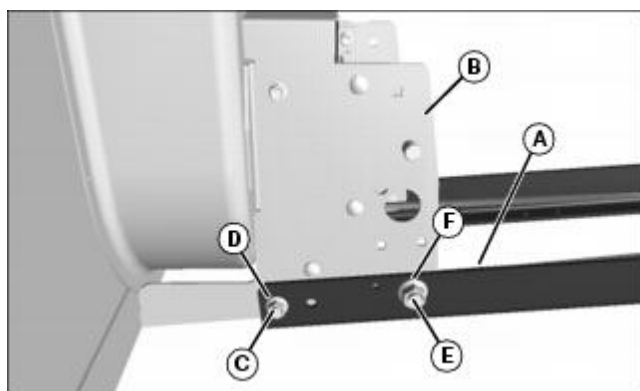

MX37533

1. Slide the frame (A) up to the back of housing (B). Align two mounting holes of the frame with two holes at the bottom of housing.
2. Install two M12x25 carriage bolts (C) through front mounting holes from the inside. Install two M12 flange nuts on carriage bolts, but do not tighten.
3. Install two M16x30 hex head bolts (E) through the rear mounting holes in the housing from the inside. Place two M16 flange nuts on bolts.
4. Tighten all hardware.

Assemble Chute to Snowblower Housing

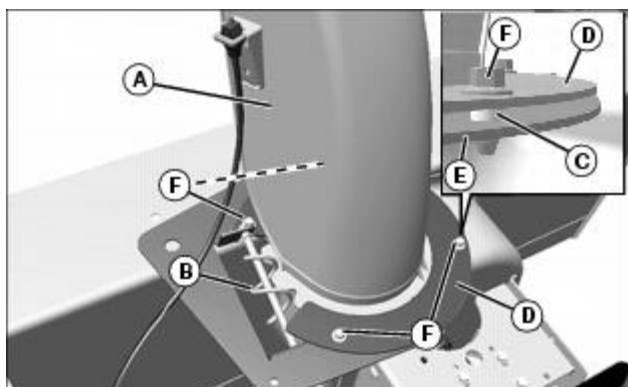

MX36798, MX38102

1. Install chute assembly (A) on chute base, with teeth on chute aligned with spiral rod (B). Install four bushings (C) and retaining bracket (D) on chute base (E) and secure with four M8x20 self-tapping screws (F). Tighten hardware.

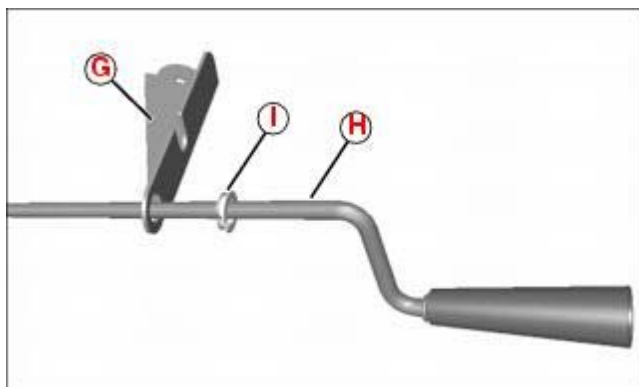

MX37427

2. Slide chute control bracket (G) onto chute control handle (H), with slotted flange facing the handle end. Install split bearing (I) onto handle side with smaller flange of bearing toward bracket. Push bearing into bracket by working counterclockwise from the split to secure.

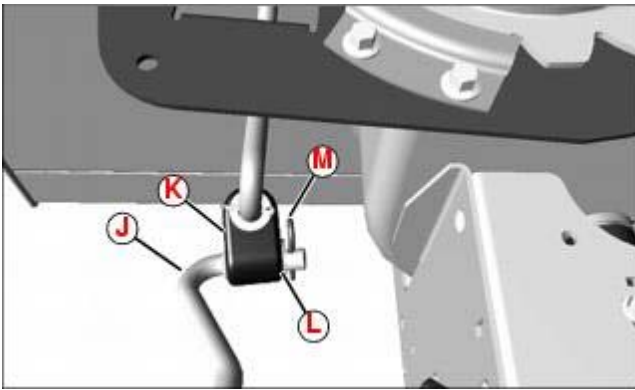

MX36808

3. Insert end of chute control handle (J) into U-joint (K) at end of spiral rod, and secure with an M10.5 washer (L) and spring locking pin (M).

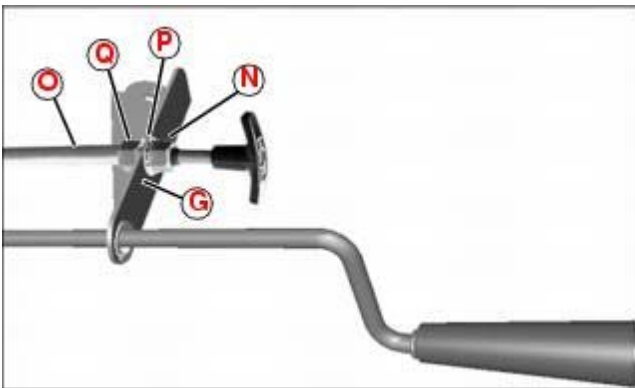

MX37428

4. Thread top nut (N) on spout cable (O) as far as possible.

NOTE: Handle must be in vertical position when tightening to allow proper operation.

5. Put handle end of cable into slot in chute control bracket (G) with lock washer (P) against top nut (M) and bottom nut (Q) against bottom side of bracket. Tighten nuts to secure.

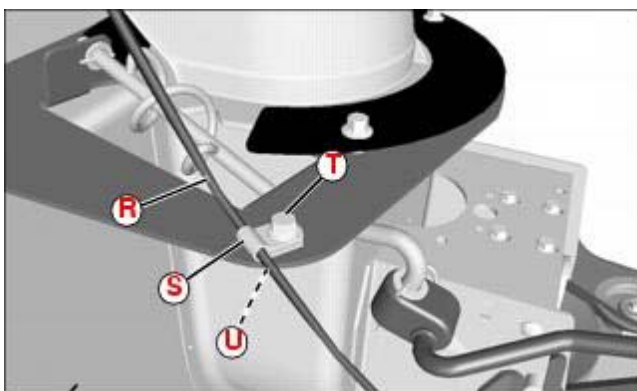

MX37792

6. Secure spout cable (R) to the left rear mounting hole in the chute base, using clamp (S), M6x16 flange head bolt (T), and M6 nut (U). Do not tighten completely. Cable should be able to slide in clamp, and clamp should be able to pivot freely.

Install Lift Lever

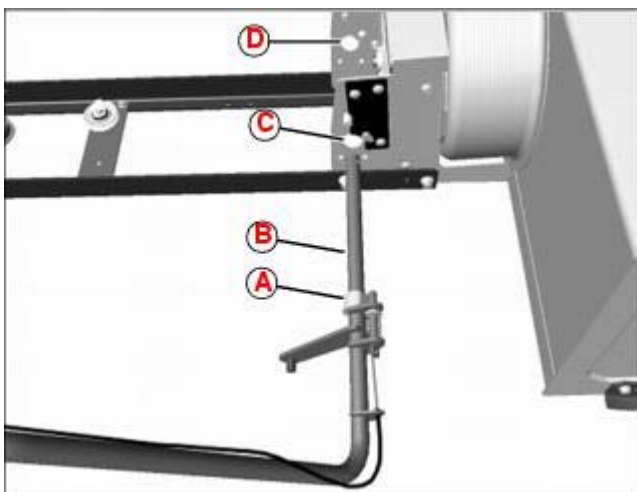

MX37534

1. Assemble bearing (A) onto lift lever assembly (B) with flange toward the outside. Slide lift lever into large hole (C) in right side of housing and out through large hole (D) in left side of housing. Make sure bearing seats in hole (C) and bearing flange is tight against housing.

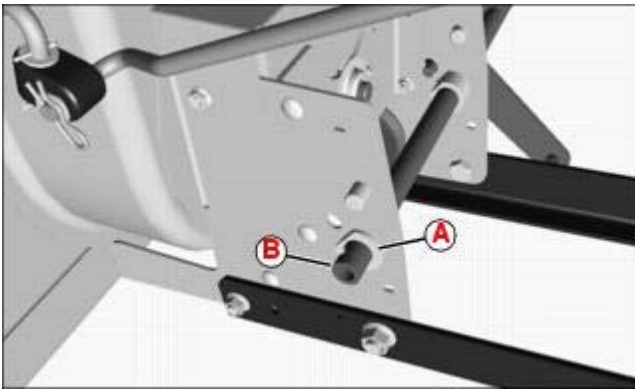

MX37535

2. Install the remaining bearing (A) on the left end of the lift lever (B) and slide into hole in housing until flange is against housing.

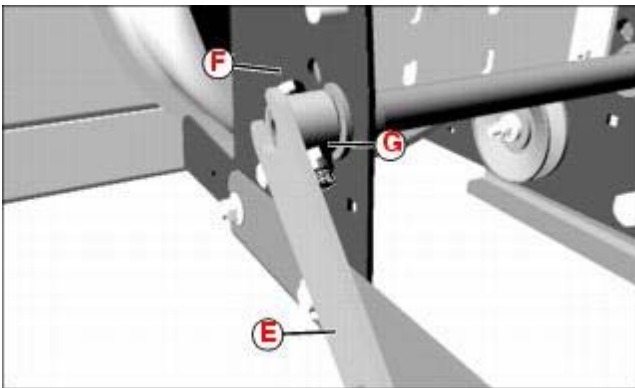

MX37536a

3. Install lift arm (E) on the left end of the lift lever and align the cross hole in the lift arm with the cross hole in the lift lever. Secure with an M10x55 bolt (F) and M10 locknut (G).

Install Secondary Belt

NOTE: The secondary belt is supplied already installed on the sheave at the housing. It has to be routed to the sheaves at the rear of the frame.

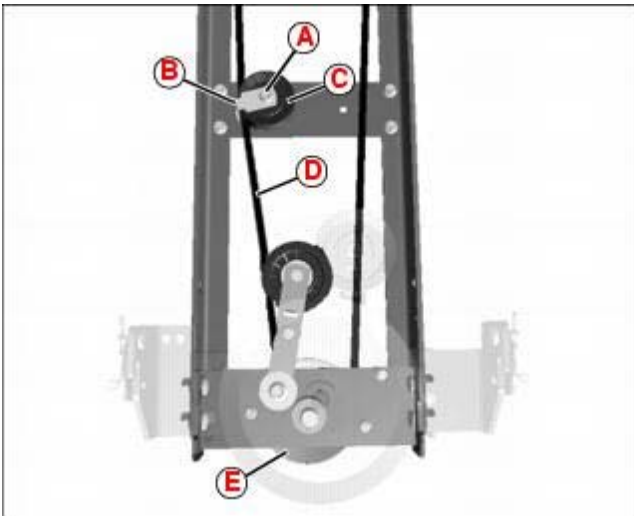

MX38101

Picture Note: Upper drive components not shown.

1. Remove and retain nut (A) and belt guide (B) at idler sheave (C).
2. Route secondary drive belt (D) from housing around outside of idler sheave (C), and secondary (lower) drive sheave (E).
3. Locate secondary belt tensioning spring.

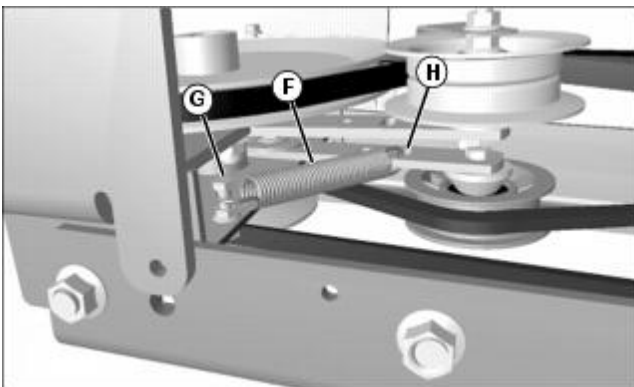

MX37539

4. Hook either end of the spring (F) over bolt (G) at the right side of the frame, and the other end into the slotted hole (H) in the tensioning arm.

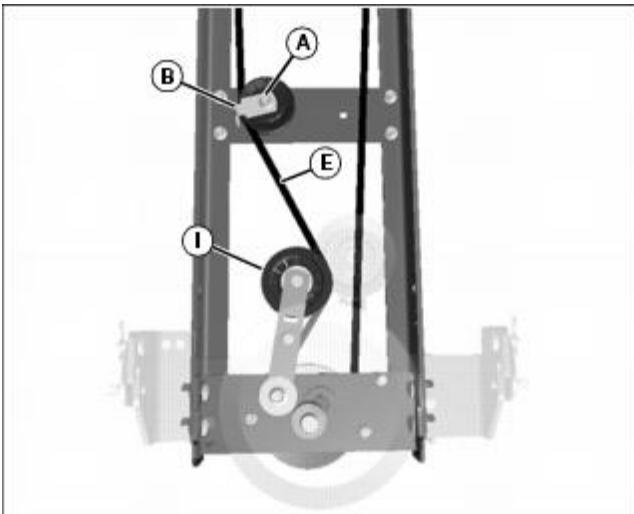

MX37538

Picture Note: Upper drive components not shown.

5. Pull tensioning arm back toward frame and route secondary drive belt (E) to the inside of tensioning sheave (I).

6. Install and tighten belt guide (B) and retaining nut (A), removed earlier.

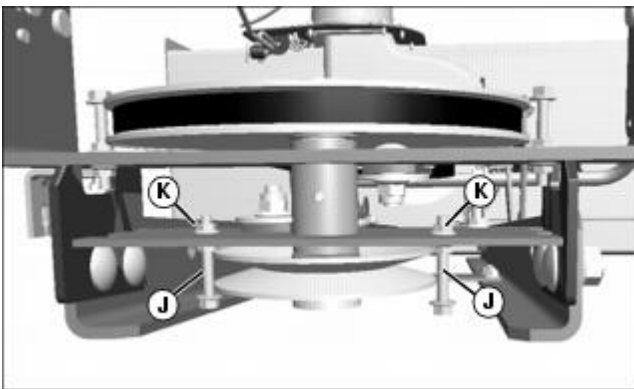

MX37537

7. Install M6x45 belt guard bolts (J) and M6 nuts (K) at the rear of the frame.

Install Tensioning Springs

NOTE: Electric and manual mower engagement machines require different primary belt tensioning springs. Select correct spring for machine this snowblower will be installed on.

Install Primary Belt Tensioning Spring (Electric Mower Engagement)

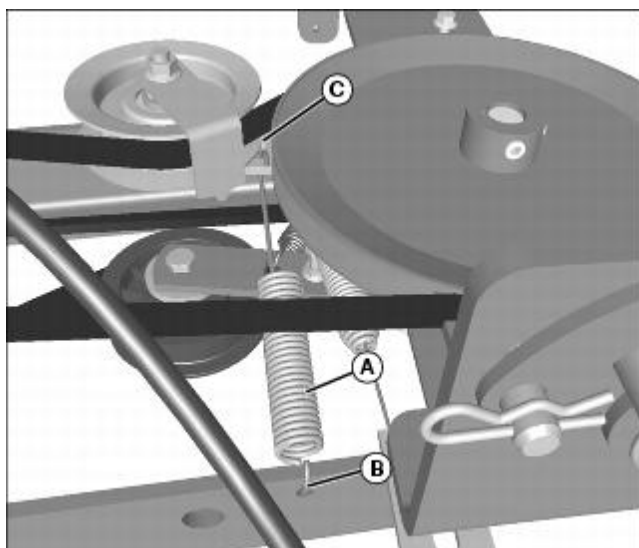

MX37541

1. Locate primary belt tensioning spring for electric mower engagement machines.
2. Install short end of spring (A), hook end up, into anchor hole (B) at left side of frame, and long end of spring, hook end up, in slot (C) in the primary (upper) tensioning arm.

Install Primary Belt Tensioning Spring (Manual Mower Engagement)

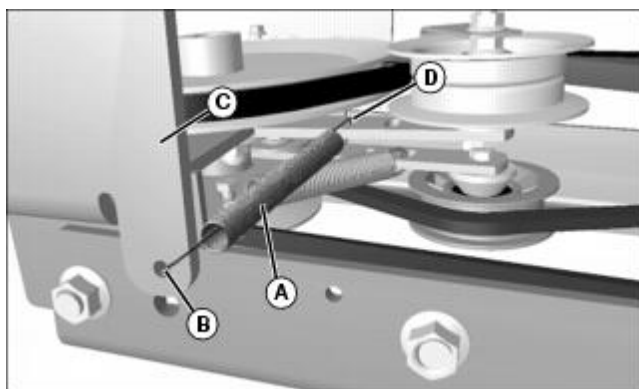

MX37540

1. Locate primary belt tensioning spring for manual mower engagement machines.
2. Hook either end of spring (A) into anchor hole (B) at the front of hanger bracket (C) at right side of frame, and the other end of spring into round hole (D) in primary (upper) tensioning arm.

Copyright © 1996-2008 Deere & Company. All Rights Reserved. [About Our Site](#) | [Privacy](#) | [Legal](#)

Product Manuals

OPERATOR'S MANUAL

Preparing Vehicle

Install Front Mounting Plates

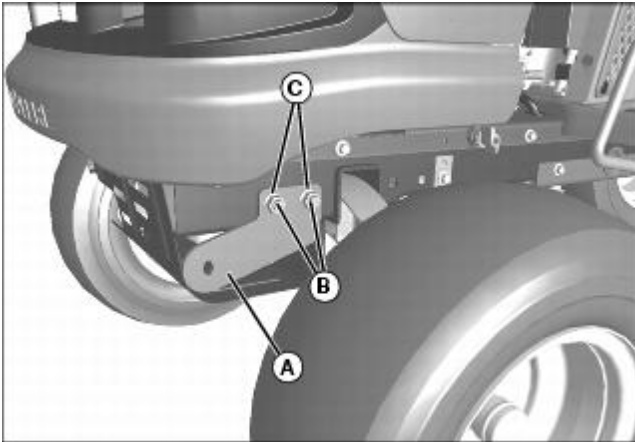

MX37479

1. Align holes in front mounting plate (A) with mounting holes on machine.
2. Install two M10x25 carriage bolts (B) from inside of frame, and secure with two M10 flange nuts (C).
3. Tighten hardware.
4. Repeat procedure for other side.

Install Rear Mounting Plates

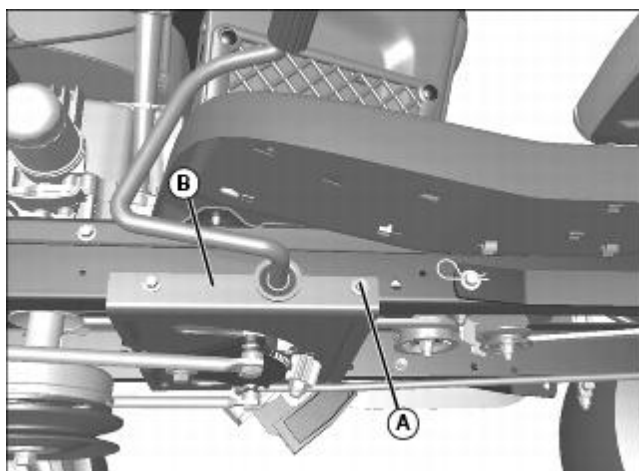

MX37480

1. Remove and discard bolt (A) that secures rear of steering support plate (B) to machine frame at left side of machine.

NOTE: When installing right rear mounting plate, take care not to pinch an existing wire that runs inside the frame.

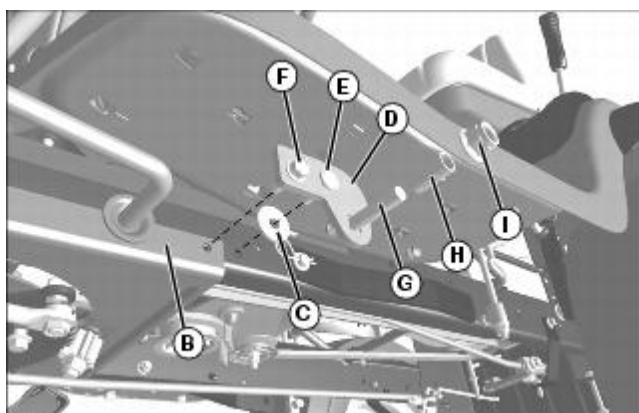

MX37481

2. Place M11x34 OD washer (C) and rear mounting plate (D) on steering support plate (B) and machine frame then install M10x30 carriage bolt (E). Install M10 flange nut on carriage bolt, but do not tighten.
3. Install M8x25 flange head bolt (F) through rear mounting plate hole and threaded hole in machine frame. Install M8 flange nut on bolt.
4. Tighten all hardware.
5. Install M12x55 carriage bolt (G) through the square hole in mounting plate from the inside out. Install an M12x30 bushing (H) over carriage bolt and secure with an M12 flange locknut (I). Tighten hardware.

6. Repeat procedure for other side.

Install Reflective Tape



MX36816

Apply reflective tape (A) to rear bumper of machines without reflectors.

Copyright © 1996-2008 Deere & Company. All Rights Reserved. [About Our Site](#) | [Privacy](#) | [Legal](#)

Product Manuals

OPERATOR'S MANUAL

Installing

Preparing the Machine

NOTE: Read and complete the assembly procedures if installing the attachment for the first time.

Before installing attachment, remove mower from machine. (See Removing and Storing Mower section in machine operator's manual.)

Machine Setup

- Check tire pressure of machine before operating machine.

Installing Ballast



CAUTION: Avoid injury! Machine can become unstable when operating with attachment. Ballast is required when the attachment is installed.

When the attachment is removed, also remove any ballast that was added to the machine.

Use only attachments and accessories recommended by the manufacturer.

Installing the recommended rear ballast will help counter-balance the weight of the snowblower. Remove ballast when the snowblower is removed. This will ensure proper operation of the machine when not removing snow.

Recommended Ballast:

NOTE: Rear Weight Bracket Kit (BG20022) is required for rear weight use.

- Two 19 kg (42 lb.) Rear Suitcase Weights (R66949).

Remove Mower

1. Remove mower deck. (See Removing and Storing Mower section in machine operator's manual.)

2. Remove mower deck drive belt and store with mower deck.

Installing Snowblower

1. Slide frame under machine with rear hanger brackets on frame positioned under the rear mounting plates on the machine.

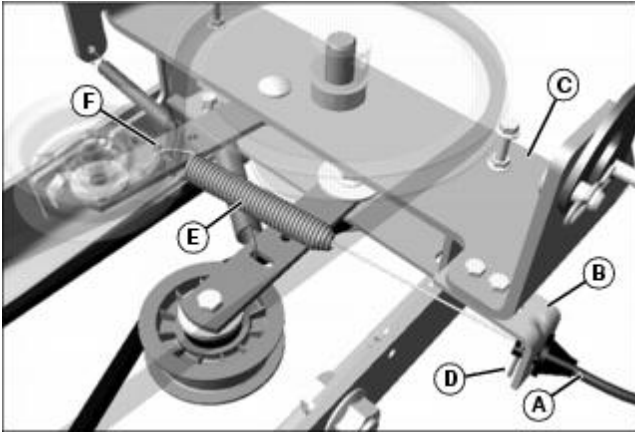

MX37450

Picture Note: Upper drive components not shown.

2. With frame on the ground, connect mower engagement cable (machines with manual mower engagement only).

- a. Install mower engagement cable (A) in slot in cable bracket (B) at left side of drive system plate (C).
- b. Secure cable in bracket with spring locking pin (D).
- c. Hook end of cable spring (E) into slotted hole (F) in primary (upper) tensioning arm.

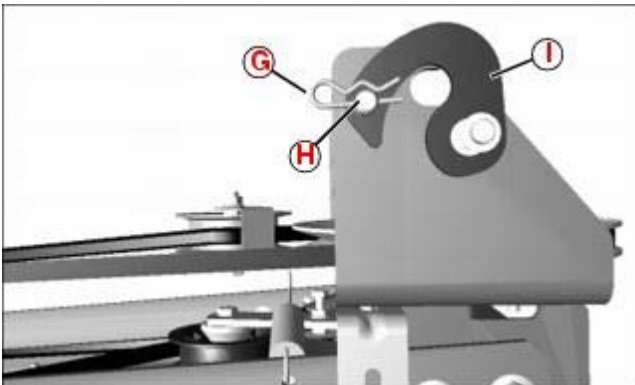

MX37451

3. Remove spring locking pin (G) and drilled pin (H) that secures the latch (I) to the hanger bracket at both sides of the machine. Rotate the latch backwards to expose the slot in the hanger bracket.

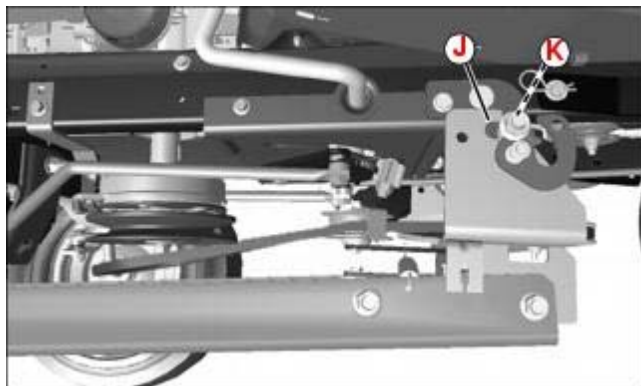

MX37485

4. Lift the back of frame and align the slot (J) of the hanger bracket with the long bushing (K) at the rear mounting plate at each side of the machine.

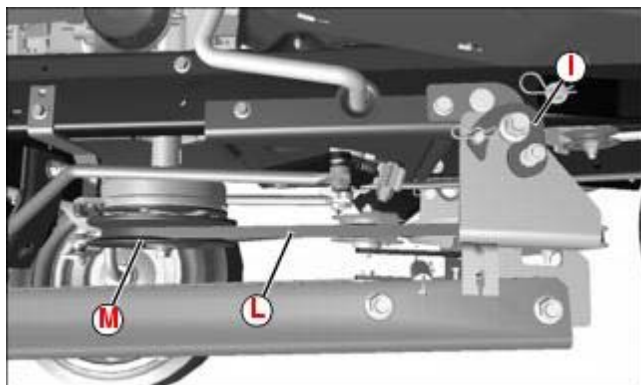

MX37486

5. Slide the frame backwards to fully engage the hanger brackets, rotate the latch (I) to closed position on each side and secure with drilled pins and spring locking pins, removed earlier.

6. Install primary drive belt (L) on machine drive sheave (M).

NOTE: Adjustable lift link must be assembled with stud in low position (for maximum lift) for tractors with 15 in. front tires, or in high position (for minimum lift) for tractors with 16 in. front tires.

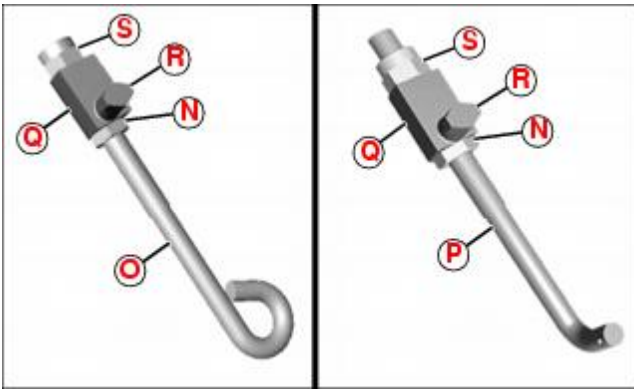

MX39849

Picture Note: Lift link orientation for 15 in. front tires shown.

7. Assemble adjustable lift link to adjustable lift rod (one assembly per side):

- Thread M10 nut (N) onto adjustable lift rod (O) (SN-020000) or (P) (SN020001-).
- Slide adjustable lift link (Q) onto lift rod with mounting leg (R) toward the bottom (15 in. front tires) or the top (16 in. front tires), and secure with an M10 locknut (S).

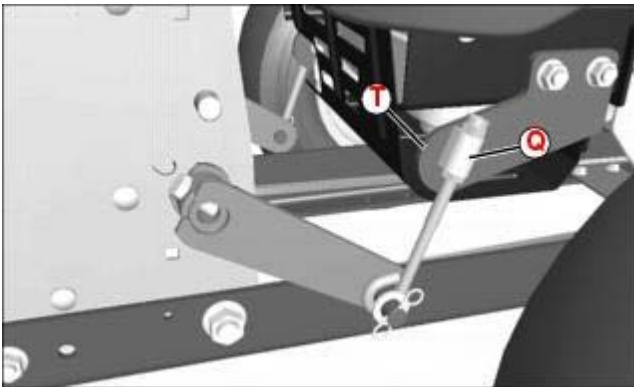

MX37445

Picture Note: SN -020000 shown.

8. Install mounting leg of each adjustable lift link (Q) into front mounting plate (T), and pivot it downward.

9. Install lift rod to lift arm:

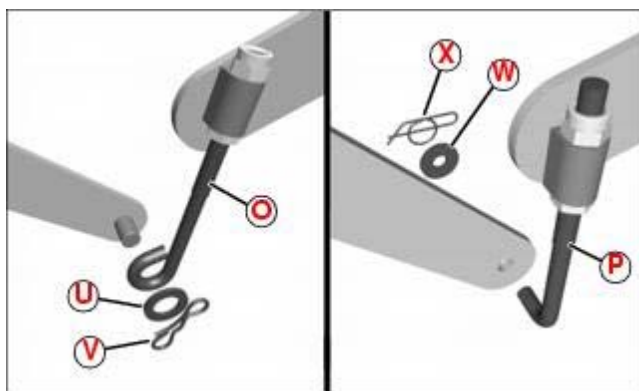

MX39850

- For machines (SN-020000) - Install loop on each lift rod (O) over mounting pin on lift arm and secure with M17x28 OD washer (U) and spring locking clip (V).
- For machines (SN020001-) - Install lower end of each lift rod (P) into mounting hole in lift arm and secure with M10x30 OD washer (W) and locking cotter pin (X).

10. Tilt hood forward.

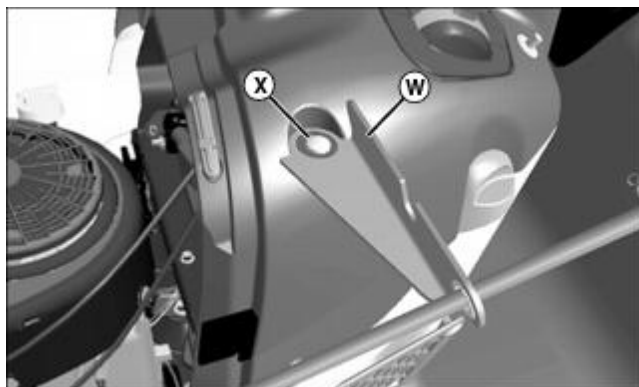

MX37487

Picture Note: Spout control cable not shown.

11. Position chute control bracket (Y) on console and install M6x45 carriage bolt (Z). Install M6 serrated lockwasher, M6.4 washer and M6 wingnut on carriage bolt from underneath hood. Tighten securely.

12. Lower hood.

13. Adjust lift height. See “Adjusting Lift Height” in Operating section.

Check Tire Pressure

IMPORTANT: Avoid damage! To prevent tire damage, do not use more than maximum tire pressure shown on sidewall of tire.

NOTE: See your Machine Operator's Manual for correct tire pressure.

Check tire pressure with an accurate gauge.

Add or remove air, if necessary.

Copyright © 1996-2008 Deere & Company. All Rights Reserved. [About Our Site](#) | [Privacy](#) | [Legal](#)

Product Manuals

OPERATOR'S MANUAL

Removing and Storing

Removing Snowblower

1. Park machine safely. (See Parking Safely in Safety section.)
2. Disengage lift lock, and lower snowblower to the ground.
3. Tilt hood forward.

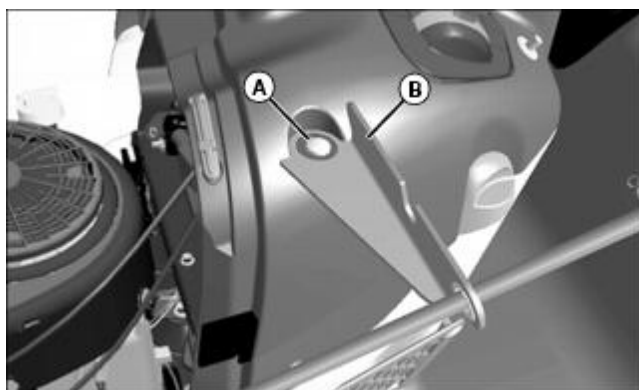

MX37487

Picture Note: Spout control cable not shown.

4. Remove M6 wingnut, M6.4 flat washer and M6 serrated lockwasher that secure M6x45 carriage bolt (A) under console. Lift chute and spout bracket (B) and carriage bolt from console, and install hardware back onto carriage bolt for storage.

NOTE: Chute and spout bracket, with chute rod and spout cable assembled, can be stored with snowblower without disconnection.

5. Pivot assembled chute rod, spout cable and bracket and lower to the ground. Do not disconnect any components from the bracket, or from the snowblower.
6. Lower hood.

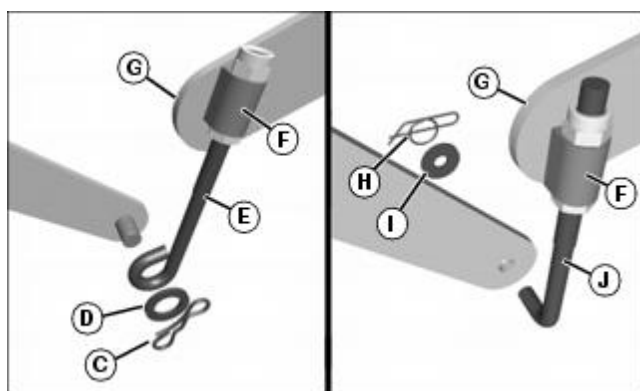

MX39850

7. Disconnect and remove lift rod:

- For machines (SN -020000) - Remove spring locking clip (C) and M17x28 OD washer (D) securing lift rod (E) at each side of the machine. Remove lift rod from lift arm pin, and pivot assembly to disengage lift link (F) from front mounting plate (G).
- For machines (SN020001-) - Remove locking cotter pin (H) and M10x30 OD washer (I) securing lift rod (J) at each side of the machine. Remove lift rod from lift arm and pivot assembly to disengage lift link (F) from front mounting plate (G).

8. Replace adjustable lift rod/link assemblies on the lift arms, and secure with hardware removed earlier for storage.

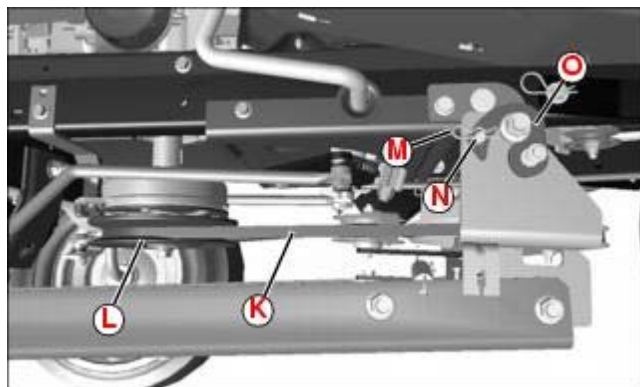

MX37486

9. Remove primary drive belt (K) from machine drive sheave (L).

10. Remove spring locking pin (M) and drilled pin (N) at each hanger bracket, and rotate latch (O) to the rear to expose the hanger slot.

11. Pull the snowblower forward. The hanger brackets will disengage from the hanger bushings on the rear mounting plates, and the snowblower frame

will drop to the ground.

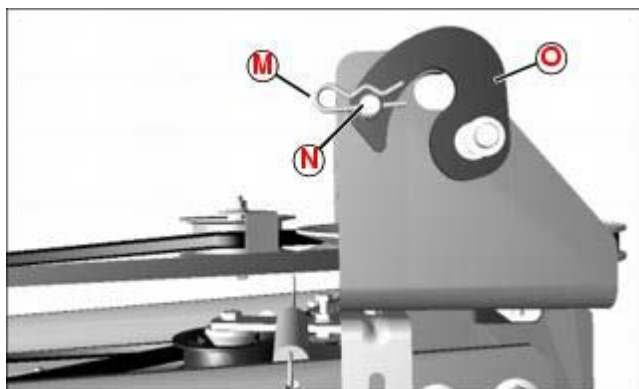

MX37451

12. Rotate the latch (O), at each side of the machine, forward to the closed position, and install the drilled pin (N) and spring locking pin (M), removed earlier, for storage.

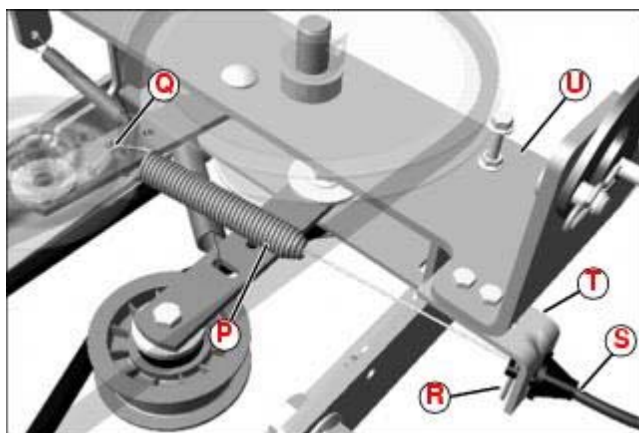

MX37450

Picture Note: Upper drive components not shown.

13. With frame on the ground, disconnect PTO cable (machines with mechanical PTO only).

- a. Remove cable spring (P) from slot (Q) in primary (upper) tensioning arm opposite the tensioning spring.
- b. Remove spring locking pin (R) that secures cable in bracket.
- c. Remove PTO cable (S) from cable bracket (T) at left side of drive system plate (U).

14. Slide snowblower from under machine for cleaning and storage.



CAUTION: Avoid injury!

When the attachment is removed, also remove any ballast that was added to the machine.

Use only attachments and accessories recommended by the manufacturer.

15. Remove any weights that were installed when preparing machine.

Storing Attachment

NOTE: Some of the following steps may not apply to your attachment.

1. Remove attachment from machine.
2. Clean attachment and driveline, if equipped.
3. Remove any shields if needed to clean out all debris.
4. Repair or replace worn, bent, or damaged parts. Tighten loose hardware.
5. Apply paint to painted surfaces where needed to prevent rust.
6. Apply thin coat of grease to blades to prevent rust.
7. Lubricate any pivot points with engine oil to prevent rust.
8. Lubricate any grease points.

IMPORTANT: Avoid damage! Abrasive surfaces can damage attachment. Store attachment on non-abrasive surface or on wooden blocks.

9. If storing attachment outdoors, block up attachment if possible and place a waterproof cover over it.

Copyright © 1996-2008 Deere & Company. All Rights Reserved. [About Our Site](#) | [Privacy](#) | [Legal](#)

Product Manuals

OPERATOR'S MANUAL

Operating

Adjusting Lift Height

The snowblower scraper blade should be approximately 10.2 cm (4 in.) off the ground when fully raised and locked, with the machine on a level surface.

1. Park machine safely. (See Parking Safely in the SAFETY section.)
2. Raise and lock snowblower.
3. Measure from ground to bottom of scraper blade at both sides.
4. Lower snowblower to ground.

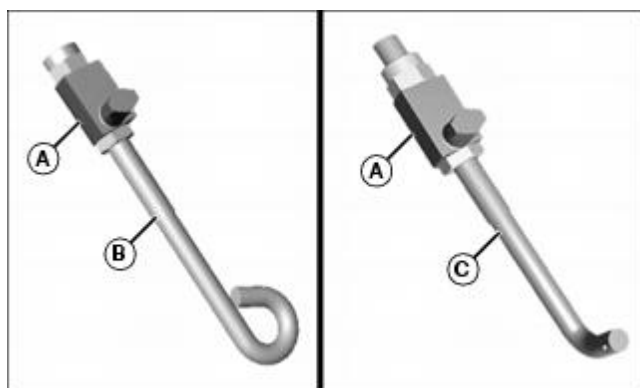

MX39849

Picture Note: Adjustable lift link (A) detail, orientation for 15 in. front tires shown, on lift rod (SN -020000) (B), and (SN020002-) (C).

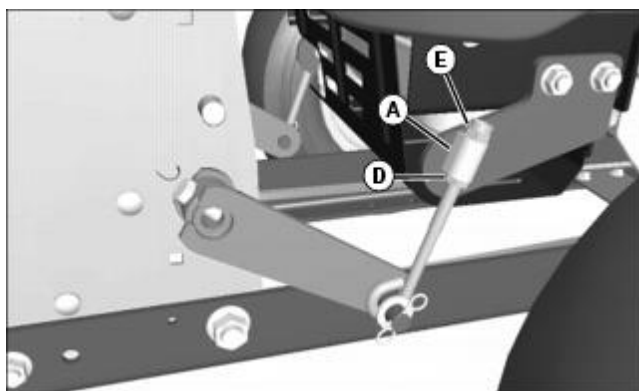

MX37445

Picture Note: SN -020000 shown.

5. Adjust lift height (each side):

- To raise lift height, loosen nut (D) and tighten nut (E) at either side of the adjustable lift link (A).
- To lower lift height, loosen nut (E) and tighten nut (D) at either side of the adjustable lift link (A).

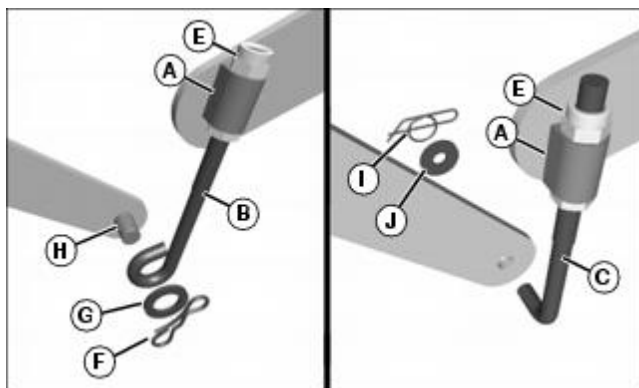

MX39850

- For more range of adjustment, the adjustable lift link (A) on the adjustable lift rod (B) or (C) can be reversed

For machines (SN -020000) - Remove the spring locking clip (F) and M17x28 OD washer (G) securing the lift link to the lift arm pin (H). Disengage the lift link from the lift arm, then pivot the lift link to allow the pivot block to be removed from the front bracket. Remove M10 locknut (E), reverse the lift link and assemble components.

For machines (SN020001-) - Remove the locking cotter pin (I) and M10x30 OD washer (J) securing the lift link to the lift arm. Disengage the lift arm and pivot the lift link to allow the pivot block to be removed from

the front bracket. Remove M10 locknut (E), reverse the lift link and assemble components.

6. Raise and lock snowblower.

7. Measure from ground to bottom of scraper blade at both sides.

8. Repeat above steps, if necessary.

Turning Discharge Chute



CAUTION: Avoid injury! Never direct discharge at bystanders or allow anyone in front of the unit. Change the discharge direction to avoid bystanders, buildings, and automobiles.



MX37409

- Turn handle (A) counter-clockwise to rotate chute to the right.
- Turn handle (A) clockwise to rotate chute to the left.

Adjusting Spout

NOTE: Pivot tension of spout (A) is not adjustable. A return spring in the chute / spout assembly assists the spout cable (B) to adjust spout angle.

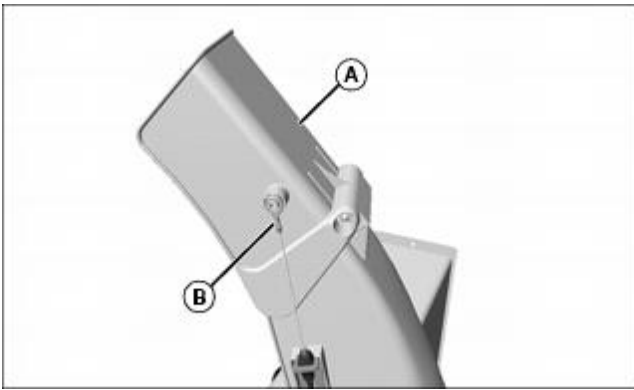

MX36818

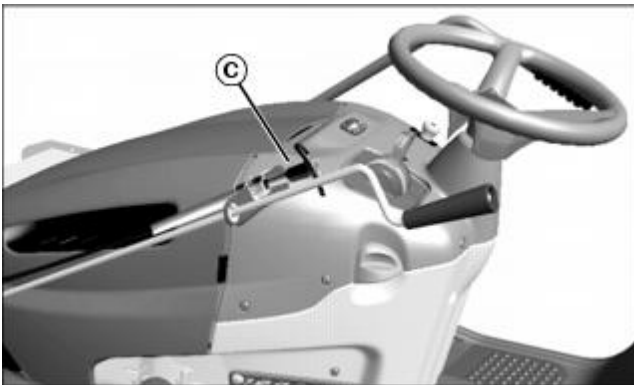

MX37409

1. Pull handle (C) to pivot spout down.
2. Push handle (C) to pivot spout up.

Adjusting Skid Shoes

NOTE: Before using snow removal attachment on gravel or uneven surfaces, lower skid shoes fully. Both skid shoes must be in the same position.

1. Park machine safely. (See Parking Safely in the Safety section.)

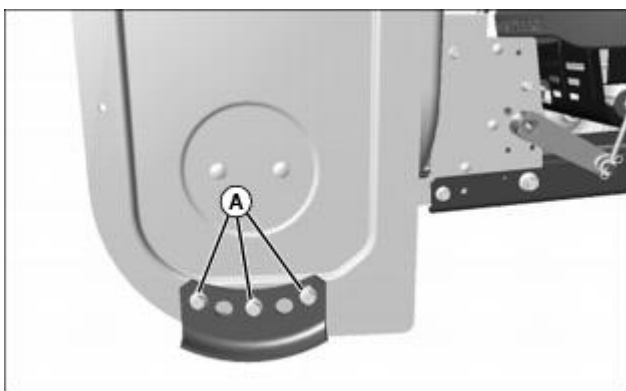

MX37407

2. Loosen bolts (A) on each skid shoe.
3. To clear snow from a flat surface, lower skid shoes so that scraper blade is 2–3 mm (1/16–1/8 in.) above surface.
4. To clear snow from a rough or a gravel surface, raise skid shoes so that scraper blade has maximum clearance.
5. Tighten bolts.

Raising and Lowering Snowblower



CAUTION: Avoid injury! Attachment can lower rapidly. Attachment is heavy and can crush.

Keep bystanders, especially children, away when lowering attachment.

Support raised attachment with a mechanical stop or lower completely to the ground before servicing.



MX37408

- To raise snowblower: Push down on lift rod handle (A).
- To lock snowblower in raised / transport position: Push down on lift handle (A) until spring loaded lift lock pin (B) engages hole in snowblower housing.
- To lower snowblower: Push down on lift rod handle (A) slightly, squeeze trigger (C) to disengage locking pin, then slowly release pressure on lift rod handle.

Operating Snowblower

1. Lower snowblower.
2. Unlock park brake.

IMPORTANT: Avoid damage! To help prevent damage to PTO clutch:

- Do not engage PTO with throttle in the fast position.

3. Engage PTO.

NOTE: Operate snowblower at full throttle for best performance.

4. Move throttle lever to full throttle position.



CAUTION: Avoid injury! Look down and behind before and while backing. Clear area of all bystanders before backing machine.

NOTE: It is necessary to engage the RIO (Reverse Implement Option) while beginning tractor movement to allow the attachment to continue running in reverse.

5. Push down on forward or reverse foot control pedal to begin movement.

Stopping Snowblower

1. Slow the machine forward speed.
2. Move the throttle to slow speed.
3. Run snowblower for several minutes after blowing snow to prevent freeze-up of the auger and impeller.
4. Disengage PTO and allow auger to stop.

5. Clean snow from snowblower before storing the machine.

Inspect, Unplug, or Park Attachment Safely

1. Stop machine.
2. Lower attachment to the ground.
3. Disengage PTO.
4. Lock park brake.
5. Stop engine.
6. Remove key.



CAUTION: Avoid injury! Rotating parts can catch fingers, loose clothing, or long hair. Wait for engine and all moving parts to stop before leaving operator's station to adjust or service machine.

7. Wait for engine and all moving parts to stop before leaving operator's seat.

Transporting



CAUTION: Avoid injury! Use extra care when loading or unloading the machine into a trailer or truck.

Close fuel shut-off valve, if your machine is equipped.

IMPORTANT: Avoid damage! Always lower attachment to trailer deck when transporting.

1. Drive machine and attachment onto heavy-duty trailer equipped with lights and signage required by law.
2. Lower attachment to trailer deck.
3. Stop engine.
4. Lock park brake.
5. Fasten machine and attachment to deck with straps, chains, or cables.

Product Manuals

OPERATOR'S MANUAL

Service

Service Intervals

IMPORTANT: Avoid damage! Operating in extreme conditions may require more frequent service intervals:

- Engine components may become dirty or plugged when operating in extreme heat, dust or other severe conditions.
- Engine oil may lose efficiency if vehicle is operated constantly at slow or low engine speeds or with frequent short trips.

Each Use

- Check for loose hardware.
- Lube discharge chute.

Beginning of Season

- Lube vertical driveshaft.
- Lube lift lock pin.
- Check and adjust lift height.
- Check skid shoes and scraper blade. Replace if necessary.
- Check V-belts, Replace if worn.

End of Season

- Lube lift lock pin.

Grease

IMPORTANT: Avoid damage! Use recommended John Deere greases to avoid component failure and premature wear.

The recommended John Deere greases are effective within an average air

temperature range of -29 to 135 degrees C (-20 to 275 degrees F).

If operating outside that temperature range, contact your Servicing dealer for a special-use grease.

The following greases are preferred:

- John Deere Multi-Purpose SD Polyurea Grease
- John Deere Multi-Purpose HD Lithium Complex Grease

If not using any of the preferred greases, be sure to use a general all-purpose grease with an NLGI grade No.2 rating.

Wet or high speed conditions may require use of a special-use grease. Contact your Servicing dealer for information.

Gear Case Oil

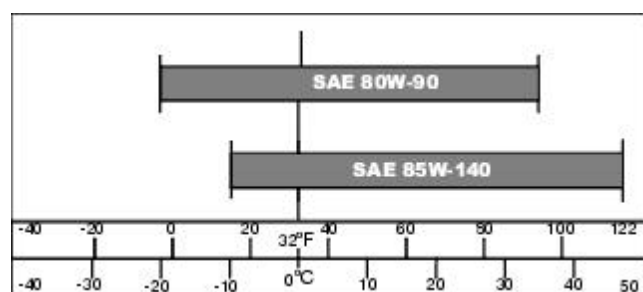

MIF

Use oil viscosity based on the expected air temperature range during the period between oil changes

The following John Deere gear case oil is preferred:

- GL-5 GEAR LUBRICANT® (SAE 80W-90)

The following John Deere gear case oil is also recommended if preferred oil is not available:

- GL-5 GEAR LUBRICANT® (SAE 85W-140)

Other gear case oils may be used if recommended John Deere gear case oils are not available, provided they meet the following specification:

- API Service Classification GL-5.

Checking Gearbox Lubricant

The gearbox does not have serviceable components. However, there is a removable plug for checking gearbox lubricant level, and adding lubricant, if necessary.

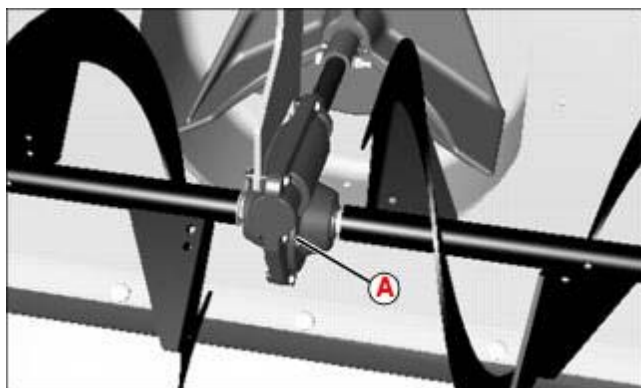

MX36990

To check gearbox lubricant level:

1. This service should be performed with the snowblower removed from the machine.
2. With blower gearbox approximately level, remove plug (A) gearbox. Lubricant level should be to the bottom of the check plug hole. Add, 80W-90 GL-5 Gear Oil, if necessary.

Replacing Shear Bolts

IMPORTANT: Avoid damage! Replacement shear bolts must be same as original shear bolts on attachment:

- Softer bolts can shear too easily.
- Harder bolts may not shear and attachment can be damaged.

1. Lower snowblower to ground.
2. Stop machine.
3. Lock park brake.
4. Remove key.

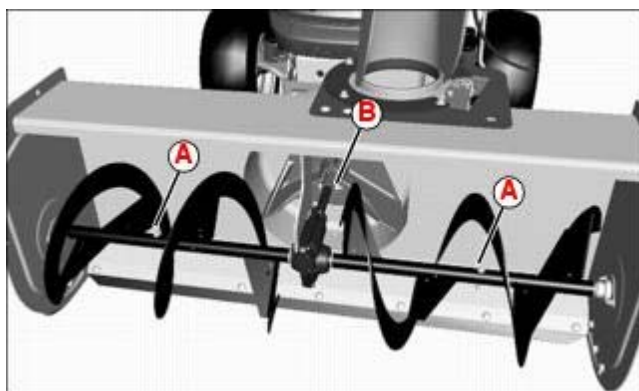

MX36988

5. Inspect to determine which shear bolt has broken. There are four shear bolts:

- One M6x45 bolt (A) and M6 nut on each auger shaft.
- Two M6x45 bolts (B) and M6 nuts securing the impeller to the auger drive shaft.

6. Find and correct the cause for shearing.

7. Lineup auger and / or impeller properly. Install new shear bolts that are same size as original, M6x45 in Impeller and M6x45 full thread in the Auger.

Replacing Scraper Blade

Replace scraper blade when blade is bent, or blade edge is rough or worn. Scraper blade is not reversible.

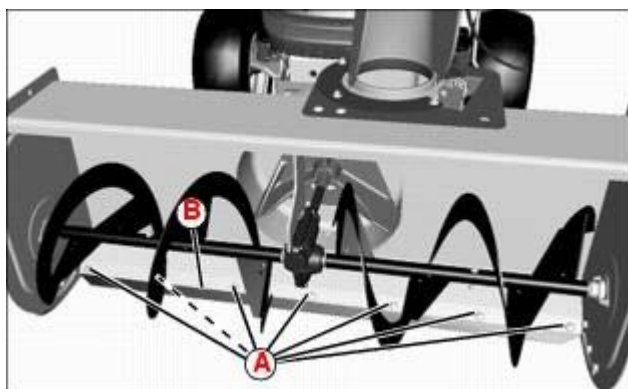

MX36988

1. Remove and retain seven M8x20 carriage bolts (A), secured at the backside with M8 locknuts.

2. Remove and replace scraper blade (B).
3. Secure scraper blade with hardware removed earlier. Tighten hardware.

Replacing Drive Belt

1. Remove snowblower from machine. See “Removing Snowblower” from Removing section.
2. Rest snowblower frame on the ground.

Replace Primary Drive Belt

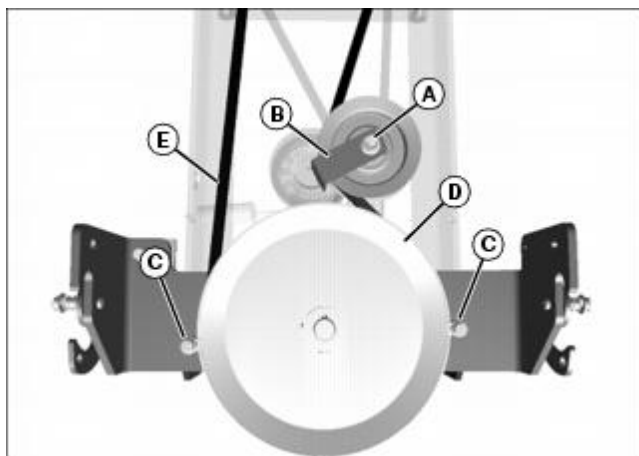

MX37560

Picture Note: Secondary drive components partially hidden for clarity.

1. Remove nut (A) and belt guard (B) from primary tensioning idler sheave.
2. Remove two retaining nuts and belt guard bolts (C) at primary drive sheave (D).
3. Remove primary drive belt (E).
4. Install new belt.
5. Install belt guards and hardware removed earlier.

Replace Secondary Drive Belt

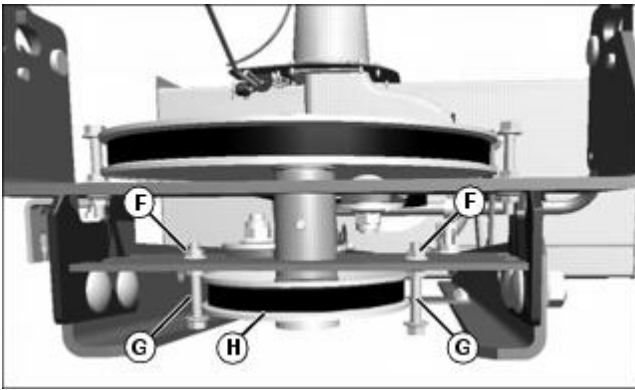

MX37561

1. Remove two nuts (F) and belt guard bolts (G) at secondary drive sheave (H).

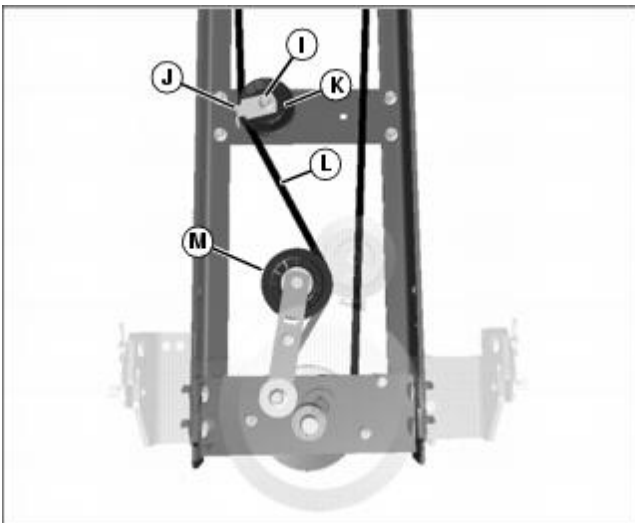

MX37538

Picture Note: Upper drive components partially hidden for clarity.

2. Remove nut (I) and belt guard (J) from idler sheave (K).
3. Disengage secondary drive belt (L) from tensioning sheave (M) and remove from secondary drive sheave.

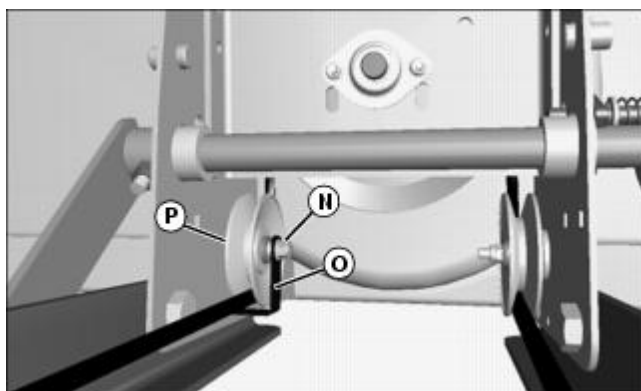

MX37562

4. Remove nut (N) and belt guard (O) from front left idler sheave (P) at rear of snowblower housing.

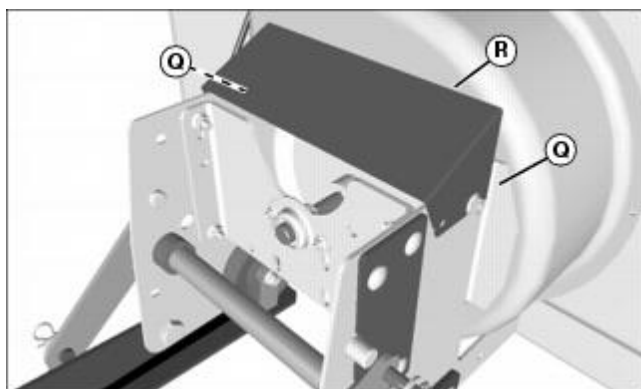

MX37563

5. Loosen, do not remove, two nuts (Q) that retain belt guard bracket (R) to snowblower housing. Remove belt guard bracket, which is slotted for easy removal and installation.

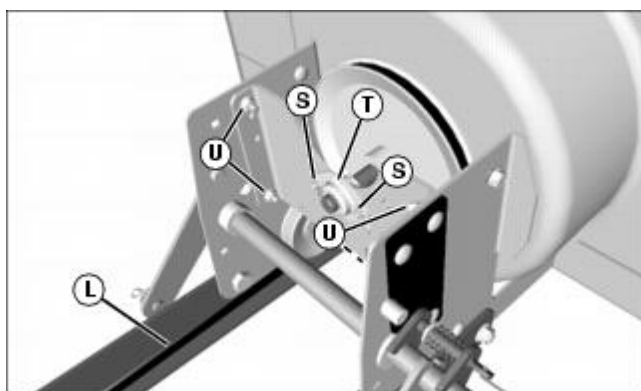

MX37564

6. Remove two nuts (S) and auger shaft bearing (T) from gearbox plate.

7. Remove four nuts (U) and carriage bolts that retain the gearbox plate to the snowblower housing. Remove gearbox plate.
8. Remove old secondary belt (L) and begin installing new one. Make sure that twist in belt is correct when routing from the front sheave past the side idler sheaves.
9. Install gearbox plate and secure with hardware removed earlier.
10. Install auger shaft bearing and secure with hardware removed earlier.
11. Install belt guard bracket and tighten retaining nuts to secure.
12. Install belt guard on front left idler pulley, with locating tab in belt guard inserted in small hole in snowblower housing. Secure with nut, removed earlier.

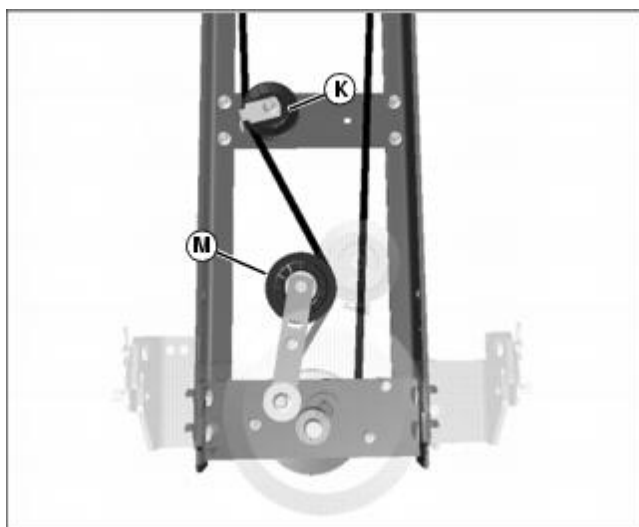

MX37538

Picture Note: Upper drive components partially hidden for clarity.

13. Rout belt back to outside of idler sheave (K), and install belt guard and nut, removed earlier.
14. Route belt to inside of tensioning sheave (M), then back over the secondary drive sheave to complete belt routing.
15. Install belt guard bolts and nuts, removed earlier, at secondary drive sheave.

Copyright © 1996-2008 Deere & Company. All Rights Reserved. [About Our Site](#) | [Privacy](#) | [Legal](#)

Product Manuals

OPERATOR'S MANUAL

Troubleshooting

Using Troubleshooting Chart

If you are experiencing a problem that is not listed in this chart, see your authorized dealer for service.

When you have checked all the possible causes listed and you are still experiencing the problem, see your authorized dealer.

Snowblower

IF	CHECK
Auger or Fan Will Not Turn	Worn or broken engine drive belt.
	Worn or broken auger drive belt.
	Broken shear bolt.
Snowblower Operation Is Erratic	Damaged scraper blade.
	Worn or broken belts.
Snowblower Removes Snow Unevenly	Level snowblower.
Rear Traction Is Poor	Install weights.
	Install chains on rear tires.
Lift Lever Will Not Lock In Raised Position	Adjust guide plate on snowblower housing.
	Adjust lift height.
Belt Wears Too Fast Or Breaks	Adjust belt guides.
	Check idler alignment.
Not Enough Lift Height Or Not Low Enough	Adjust lift height.

[Close Window](#) | [All Manuals](#)

Product Manuals

OPERATOR'S MANUAL

Specifications

Snowblower

Overall Length 77.5 cm (30 1/2 in.)

Clearing Width 1.1m (43 1/4 in.)

Scraper Blade Replaceable

Height to top of housing 46cm (18 in.)

Height to top of spout 100cm (40 in.)

Auger Speed 110 rpm

Auger Diameter 30.5 cm (12 in.)

Impeller Speed 1060 rpm

Impeller Diameter 35.5 cm (14 in.)

Lift Height (above ground level) 10cm (4 in.)

Lift Height (below ground level) 5 cm (2 in.)

Discharge Chute Rotation 200 Degrees

Net Weight 82 kg (180 lb)

(Specifications and design subject to change without notice.)

Copyright © 1996-2008 Deere & Company. All Rights Reserved. [About Our Site](#) | [Privacy](#) | [Legal](#)

Product Manuals

OPERATOR'S MANUAL

Getting Quality Service

Service Literature

If you would like a copy of the Parts Catalog or Technical Manual for this machine call:

- **U.S. & Canada:** 1-800-522-7448.
- **All Other Regions:** Your John Deere dealer.

Parts

We recommend John Deere quality parts and lubricants, available at your John Deere dealer.

Part numbers may change, use part numbers listed below when you order. If a number changes, your dealer will have the latest number.

When you order parts, your John Deere dealer needs the serial number or product identification number (PIN) for your machine or attachment. These are the numbers that you recorded in the Product Identification section of this manual.

Order Service Parts Online

Visit <http://JDParts.deere.com> for your Internet connection to parts ordering and information.

Part Numbers

Item	Part Number
Primary (Upper) Belt	M155452
Secondary (Lower) Belt	M155885
Impeller Shear Bolt (M6x45)	19M8321
AugerShear Bolt (M6x45) full thread	19M7834
Shear Bolt Nut (M6)	14M7397
Scraper Blade	M155105

Skid Shoe	M46530
-----------	--------

(Part numbers are subject to change without notice. Part Numbers may be different outside the U.S.A.)

John Deere Quality Continues with Quality Service

John Deere provides a process to handle your questions or problems, should they arise, to ensure that product quality continues with your John Deere dealer's parts and service support.

Follow the steps below to get answers to any questions you may have about your product.

1. Refer to the appropriate attachment, machine or equipment operator manuals.
2. Contact your John Deere dealer with unanswered questions.
3. In North America or Canada, call the John Deere Customer Contact Center.
 - Call 1-800-537-8233 and provide product serial number and model number.

Copyright © 1996-2008 Deere & Company. All Rights Reserved. [About Our Site](#) | [Privacy](#) | [Legal](#)