

D

C

B

A

D

C

B

A

ZONE	REV.	REVISION DESCRIPTION	ECN NO.	DATE
	D	REDRAWN IN SOLIDWORKS; PAF	ECN0031971	25-OCT-2006

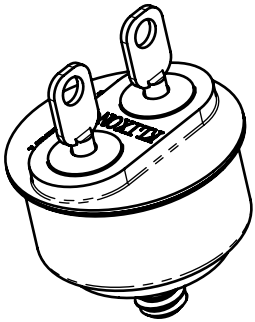

CONFIGURATION 1

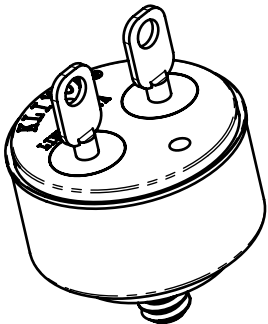

CONFIGURATION 2

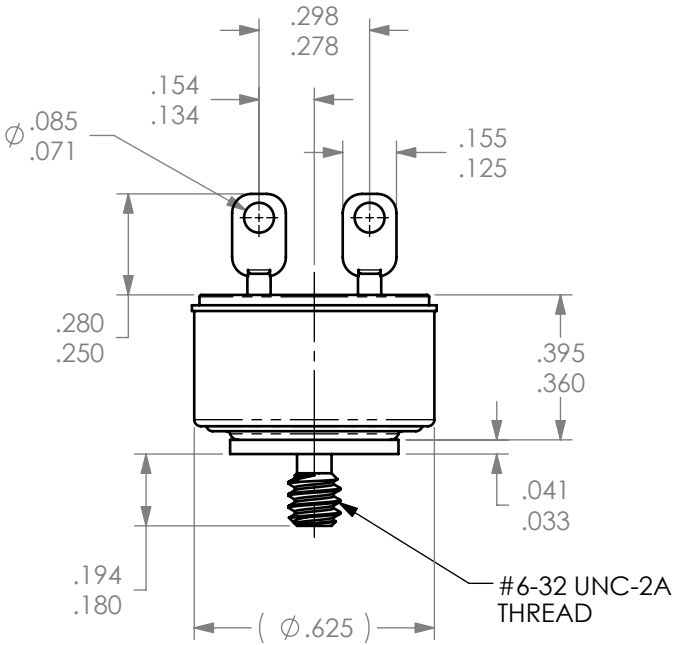
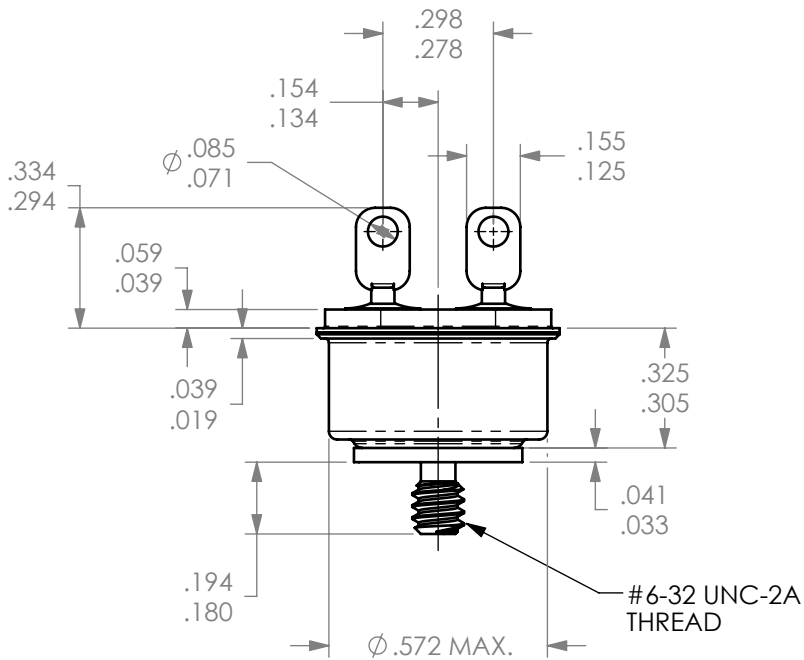
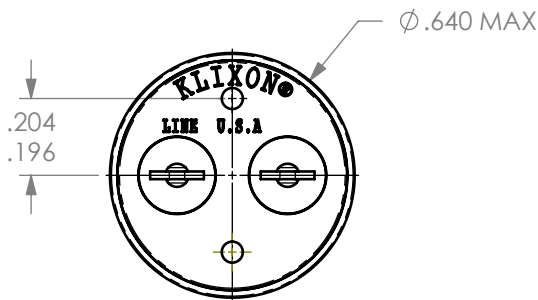
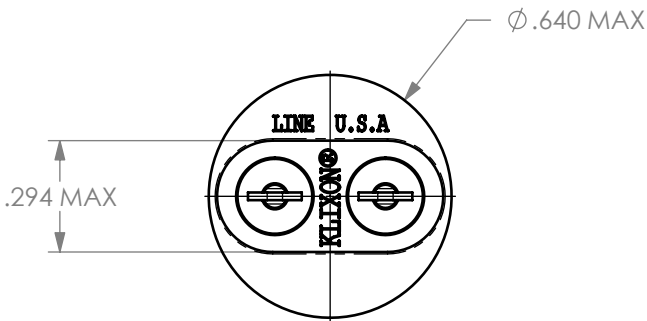

MATERIAL:
CONFIGURATION 1: COPPER-NICKEL PLATED CARBON STEEL
CONFIGURATION 2: UPATED 304L STAINLESS STEEL
DIELECTRIC STRENGTH:
TERMINAL TO CASE, 1250VAC, FOR 1 MINUTE

FOR REFERENCE ONLY, CHECK LATEST REVISION BEFORE USE.
PARTS MADE TO THIS PRINT MUST CONFORM TO E9898 REV. E

DRAWN
C. FLEURANT
DATE 26-OCT-1995

ENGINEER
S. MARQUIS
DATE 26-OCT-1995

APPROVED

DATE

APPROVED

DATE

NEITHER THIS PRINT NOR THE INFORMATION CONTAINED HEREON IS TO BE USED AGAINST THE INTERESTS OF SENSATA TECHNOLOGIES OR AGAINST THE INTERESTS OF ANY OF ITS AFFILIATED COMPANIES OR WHOLLY OWNED SUBSIDIARIES

UNLESS OTHERWISE SPECIFIED
DIMENSIONS ARE IN INCHES
TOLERANCES
DECIMALS ANGLES

THIRD ANGLE PROJECTION

DO NOT SCALE DRAWING

SIZE
B

REV.
D

529 PLEASANT STREET
P.O. BOX 2964
ATTLEBORO, MA 02703

TITLE
4344-13 THERMOSTAT
SPST AUTO RESET SEALED
ENVELOPE DRAWING

DWG NO.
4344-13

SCALE 2:1 SOLIDWORKS SHEET 1 OF 1