



All the power you'll ever need



Panasonic
Rechargeable Sealed Lead-Acid Battery
LC-R125P
Constant Voltage Charge (12V, 5Ah/20HR)
Voltage regulation
Cycle use : 14.5 ~ 14.9V (25°C)
(Initial current : less than 2.0A)
Standby use : 13.5 ~ 13.8V (25°C)
NONSPILLABLE
1-800-871-1111 (U.S.A.)



BATTERY MUST BE
RECYCLED (U.S.A.)

Panasonic
Heavy Duty
D Battery

Industrial
Panasonic Alkaline
D Battery

Industrial
Panasonic Alkaline
C Battery

Industrial
Panasonic Alkaline
AA Battery

Heavy Duty
Panasonic
AA Battery

Industrial
Panasonic Alkaline
AAA Battery

Panasonic
General Purpose
C Battery

Panasonic
Heavy Duty
AAA Battery

Panasonic
General Purpose
AA Battery

Panasonic
General Purpose
9V Battery

Industrial
Panasonic Alkaline
9V Battery
6AA-6P1 9V
NOT FOR RETAIL TRADE

Industrial
Panasonic Batteries



A l l t h e p o w e r y o u ' l l e v e r n e e d

THE ONE-STOP RESOURCE FOR INDUSTRIAL DISTRIBUTORS

Panasonic Industrial Alkaline and Specialty Products Group has initiated a Full Service Provider Program whose focus is being the one-stop resource for the industrial market. The Panasonic Industrial Battery line of products covers the entire spectrum of needs and services required by distributors. The industrial lineup includes Alkaline, Sealed Lead Acid, Carbon Zinc, and heavy-duty flashlights and lanterns. Every professional product manufactured for the Industrial Alkaline and Specialty Products Group is packaged and priced specifically for this market.

As tough as our complete line of batteries are, we still manufacture every product with the environment in mind. We've replaced mercury with new proprietary materials that allow us to maintain the high level of performance you count on, offering all the professional power you'll ever need. Our Panasonic team of scientists, researchers, systems engineers, software developers, and manufacturing technicians share the Panasonic commitment to satisfy the customer and contribute to society.

All the power you'll ever need is not only a statement on the overall superior performance and diversity of our new line of batteries and products, but also on our commitment to involving the customer in the decision making process from defining needs, to conceptualizing the product, to finally manufacturing it.



LOCAL MANUFACTURING TO MEET THE LEAD TIMES YOU DEMAND







LOCAL MANUFACTURING TO MEET THE LEAD TIMES YOU DEMAND

Panasonic's name first appeared on products destined for the U.S. market in 1961. Today, over 19,500 people make up the Panasonic team that now operates a growing network of sales, marketing, research and development, and manufacturing locations in the U.S., Puerto Rico, Mexico and Canada. In fact, it's part of Panasonic's philosophy to develop a local presence wherever and whenever possible. Currently, Panasonic has 18 manufacturing sites in North America in order to be close to the customers we're serving.



A l l t h e p o w e r y o u ' l l e v e r n e e d

ALL THE ALKALINE POWER YOU'LL EVER NEED

Performance when it counts! Our Industrials are specially designed to provide your users with a power reservoir that enables them to last longer — even under the abuse they're likely to take in industry and professional applications. All Panasonic Alkaline batteries are made in the U.S.A. at our state-of-the-art manufacturing facility in Columbus, Georgia. High current and large capacity are standard in all our Industrial batteries which means high performance for you and a five-year shelf life guarantee from us! All alkalines are available in blister packs, value packs and in bulk.

Panasonic alkaline performance when it counts!

- High current and large capacity for excellent performance
- Stable voltage and current
- Long storage life
- Built-in resistance to leakage
- Environmentally friendly
- 99.999% mercury free



THE RIGHT CHOICE FOR EVERY APPLICATION

Alkaline C	Flashlights, Radios, Tape Recorders
Alkaline D	Flashlights, Radios
Alkaline AA	Pagers, Flashlights, Remote Control Devices
Alkaline AAA	Pagers, Flashlights, Remote Control Devices
Alkaline 9V	Infusion Pumps, Wireless Microphones, Smoke Alarms, Radios



AM - 2PI Size C Alkaline

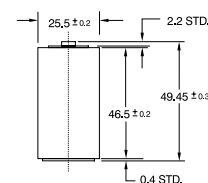

AM - 1PI Size D Alkaline

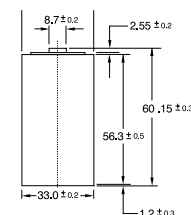

AM - 3PI Size AA Alkaline

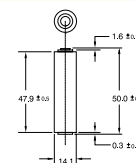

AM - 4PI Size AAA Alkaline

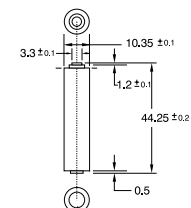

6AM - 6PI Size 9V Alkaline

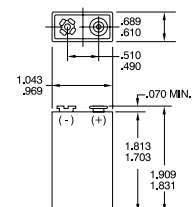

Specifications

Model Number	Voltage (v)	Diameter (in.)	Height (in.)	Av.Wt. (gms)	
AM2 (Size C)	1.5	1.031	1.969	65	
AM1 (Size D)	1.5	1.346	2.421	135	
AM3 (Size AA)	1.5	.571	1.988	14	
AM4 (Size AAA)	1.5	.413	1.752	12	
Model Number	Voltage (v)	L (in.)	W (in.)	D (in.)	Wt. (gms)
6AM6 (9V)	9	1.909	1.043	0.689	38



SEALED LEAD ACID BATTERIES

The LCR-Series is a Sealed Lead Acid rechargeable battery system. These batteries are field tested, rugged products that stand up to tough operating conditions like overcharging and deep discharge.

Through accumulated experience in high technology products such as video tape recorders, computers, and electronic equipment, Panasonic has acquired the knowledge needed for developing and manufacturing batteries with high power density. These batteries save installation space, while providing full and reliable power.

The LCR battery withstands overcharge, overdischarge, vibration and shock more readily than competitive products and is capable of extended storage. The batteries are 100% tested on-line for voltage capacity, capacity and seals. There is no need to check the specific gravity of the electrolyte or to add water during the service life. The LCR battery is totally sealed, and needs only charging for maintenance. As a result they are excellent for any demanding application.

Your battery of choice for:

- High quality and high reliability
- High power density
- Quick rechargeability
- Long service life; float or cyclic
- Maintenance-free operation



TYPICAL SEALED LEAD ACID APPLICATIONS

Communication & Telephone Equipment

Cordless portable telephones and transceivers

Office Equipment

Portable calculators, computers, electronic cash registers, printers, typewriters

Memory Back-up & UPS

UPS Systems, computers, electronic cash registers, sequencers

Tools & Engine Start-Ups

Grass and hedge trimmers, cordless drills, screwdrivers, electric saws and engine-start-ups

Instrument & Medical Equipment

Electronic instruments, measuring equipment, medical electronics, heart defibrillators

Emergency Devices:

Lights, fire and burglar alarms, communication systems, fire shutters



Specifications

Model number	Nominal voltage (V)	Rated capacity hours rate (Ah)	Length	Width	Height	Total Height	Wt. (Approx.) (lbs)	Terminal types	Battery-case resin	
									UL94HB	94V-0
LC-RB064P(a) (LCR6V4BP)	6	4.0	2.76	1.85	4.02	4.25	1.98	B/D	O	●
LC-R065P(a) (LCR-6V5P)	6	5.0	2.76	1.85	4.02	4.25	2.14	B/D	O	●
LC-RB066R5P(a) (LCR6V6.5BP)	6	6.5	5.95	1.34	3.70	3.94	2.56	B/C/D	O	●
LC-RB0610P(a) (LCR6V10BP)	6	10.0	5.95	1.97	3.70	3.94	3.93	B/C/D	O	●
LC-R0612P(a) (LCR6V12P)	6	12.0	5.95	1.97	3.70	3.94	4.30	B/C/D	O	●
LC-LA1233P(a) (LCL-12V33AP)	12	33	7.70	5.12	6.10	7.09	26.5	M5	O	●
LC-RB124P(a) (LCR12V4BP)	12	4.0	3.54	2.76	4.02	4.26	3.84	B/D	O	●
LC-R125P(a) (LCR-12V5P)	12	5.0	3.54	2.76	4.02	4.26	4.25	B/D	O	●
LC-RB126R5P(a) (LCR12V6.5BP)	12	6.5	5.95	2.54	3.70	3.94	5.00	B/C/D	O	●
LC-R127R2P(a) (LCR12V7.2P)	12	7.2	5.95	2.54	3.70	3.94	5.45	B/C/D	O	●
LC-RB1210P(a) (LCR-12V12PF)	12	12	5.95	4.00	3.70	4.01	8.60	B/C/D	O	●

Note: Battery cases marked with a circle (O) are the normal product using the standard resin. Those marked with a filled circle (●) are of user specifications as per special order



INDUSTRIAL FLASHLIGHTS AND LANTERNS



Taskmaster™ series: These specialty flashlights, lanterns and hands-free head lights, made of scratch-resistant high tech plastic are tough enough to withstand drop tests from seven feet onto concrete. Every light comes with a lifetime warranty and has earned the Underwriter Laboratories approval.

- Heavy-duty lanterns are water-resistant, and switches are tested to operate over 10,000 cycles
- Hands-free head light comes with a wide, adjustable elastic headband and padded headrest

Panasonic Industrial series: Whatever the job, from heavy-duty industrial to emergency services, Panasonic Industrial Flashlights combine top-of-the-line professional performance with durability nobody else can touch. All lights must pass rigorous tests geared for its specific industry. Our Division 1 Safety Approved lights are manufactured specifically for hazardous conditions.

Taskmaster Series

Style	Model #/ Color	UPC Code	Description	Quantity Case/ Case Size	Total lbs./kg	Bulb/ Brightness
Heavy-Duty Light	FF-107PA/K/ Gray	73096-80044	Includes 2-D cells Water-Resistant	12 per case 11.1"x18.2"x11.5"	8.5/3.86	Krypton MB-24PK1E Light output of over 100 candles at 5 feet
Heavy-Duty Light	FF-307PA/K/ Gray	73096-80045	Includes 2-AA cells	12 per case 9.8"x10.6"x8.7"	2.1/.95	Krypton MB-24PK3E Light output of over 50 candles at 5 feet
Heavy-Duty Lantern	FF-3PA/K/ Gray/black	73096-80046	Includes 4-D cells lantern	12 per case 20"x19.5"x12.6"	22/9.9	Krypton MB-48P75XPA Light output of over 200 candles at 5 feet
Hands-Free Headlight	BF-178PA/1B Gray/black	73096-8004	Uses 2-AA cells Includes spare bulb	12 per case 15.5"x13.5"x6.5"	4.4/1.99	2.5V 0.3Amp

Panasonic Industrial Series

Type	Model #	Casing/Color	Description	Switch	Bulb	Design
Industrial	Heavy-Duty #1618 2-D cells	Crush resistant thermoplastic Yellow with black trim	Unbreakable Tuflexx ® lens Steel reinforced	250,000 cycle 2-way switch with switch guard	PR2	Metal reinforced ring threads and top ring
Industrial	Standard #2618 2-D cells	Crush resistant thermoplastic Yellow with black trim	Tuflexx ® lens Anti-roll design Lens ring stand- offs	250,000 cycle 2-way switch with switch guard	PR2	Faceted reflector, Internal battery protection
Industrial	Standard #2702 2-AA cells	Crush resistant thermoplastic Yellow with black trim	Tuflexx ® lens Anti-roll design Lens ring stand- offs	250,000 cycle 3-way switch with switch guard	KPR104	Ring hanger, Internal battery protection
Rubber	#RBR210 2-D cells	Thermoplastic rubber resistant to most oils, chemicals, greases Orange and black trim	Anti-roll design Unbreakable Tuflexx ® lens Lens ring stand- offs	250,000 cycle switch with switch guard	KPR102 with spare bulb holder	Temperature resistant -40° to 250°F, Internal battery protection, Faceted reflector
Waterproof	#1918 2-D cells	Crush-resistant thermoplastic Yellow with black trim	Anti-roll design Tuflexx ® lens Lens ring stand- offs	3-way switch with switch guard	PR2 with spare bulb holder	Ring hanger
Division I Safety Approved	#2217 2-D cells	Crush-resistant thermoplastic Orange with black trim	Unbreakable Tuflexx ® lens Waterproof Lens ring stand-offs	3-way switch with switch guard	PR2 with spare bulb holder	Circuit breaker mechanism, Internal battery protection, Ring hanger
Division I Safety Approved	Lantern #2206 6V spring terminal	Crush-resistant thermoplastic Orange with black trim	Tuflexx ® lens Waterproof Glove-size handle	3-way switch with switch guard	PR13 with spare bulb holder	Circuit breaker mechanism, Internal battery protection
Division I Safety Approved	#2208 6V spring terminal	Orange with black trim	Tuflexx ® lens	3-way switch	PR13	Circuit breaker mechanism
Medical Designed for Hospitals	#2603 2-D cells	Industrial strength White	Anti-roll design Refillable	2-way switch	PR2 with spare bulb holder	Internal battery protection
Medical Designed for Hospitals	#2703 2-AA cells	Industrial strength White	Anti-roll design Refillable	3-way switch	KPR104	Internal battery protection, Ring hanger

Safety Approval Classifications for Division I Lights

Panasonic Safety Approved Flashlights having ASTM Type II and MSHA approvals.

Underwriter Laboratories Approvals: #2206 - Class I Group C & D, Class II Group G, Class III - #2217 - Class I Group C & D, Class II Group G - #2208 - Class I Group D - Canadian UL Approvals - #2217 - Class I Group C & D, Class II Group G

Canadian Standards Association: #2217 - Class I Group C & D, Class II Group G - #2206 - Class I Group C & D, Class II Group G - #2208 - Class I Group D - Warning: Not listed or approved for use with Halogen, Krypton, or similar high-intensity bulbs.



PEAK PERFORMANCE AT THE RIGHT PRICE



Our Carbon Zinc batteries are built for professional applications that offer peak performance at the right price. And just like our industrial alkalines we've replaced the mercury with new proprietary materials due to environmental concerns.

Heavy Duty: Design improvements for a tighter seal and stronger outer metal jacket have resulted in a high performance heavy-duty battery offering increased leakage protection and extended discharge. They are packaged in blister packs, Value Packs and bulk, with an extended shelf life of up to three years.

General Purpose: We are one of the few battery manufacturers who can offer a full line of general purpose industrial batteries. Our batteries offer maximum cost performance in low-drain, intermittent applications and provide extended shelf life of up to 18 months.

Heavy Duty Batteries

Model Number	Voltage (v)	Diameter (in.)	Height (in.)	Av.Wt. (gms)
UM-1D (Size D)	1.5	1.339	2.421	98
UM-2D (Size C)	1.5	1.031	1.969	48
UM-3D (Size AA)	1.5	.571	1.988	18

Model Number	Voltage (v)	L (in.)	W (in.)	D (in.)	Wt. (gms)
006PD (9V)	9	1.909	1.043	0.689	38

General Purpose Batteries

Model Number	Voltage (v)	Diameter (in.)	Height (in.)	Av.Wt. (gms)
UM-1 (Size D)	1.5	1.339	2.421	88
UM-2 (Size C)	1.5	1.031	1.989	44
UM-3 (Size AA)	1.5	.571	1.988	15



Fax Back Form

Industrial Battery and Lighting Information

Fax to: (201) 392-6361

☐ *I'm interested in your batteries and flashlights for the following uses:*

Battery Applications:

- ☐ Industrial
- ☐ Telecommunication Devices
- ☐ Data Collection Terminals
- ☐ Test and Measurement Devices
- ☐ Medical Equipment
- ☐ Other: _____

Flashlight Applications:

- ☐ General Use
- ☐ Safety/Emergency
- ☐ Standard Industrial
- ☐ Heavy Duty Industrial
- ☐ Utility Lanterns

Business Category:

- ☐ Government ☐ Manufacturing ☐ Services ☐ Distribution ☐ Other _____

First Name: _____ Middle Initial: _____ Last Name: _____

Title _____

Company: _____

Address: _____

City: _____

Mail Stop: _____

State/Province: _____ Zip Code: _____

Country: _____

Phone: _____

Fax: _____

E-mail: _____

Your company's web address: WWW. _____



A l l t h e p o w e r y o u ' l l e v e r n e e d



CROSS REFERENCE GUIDE

Specifications:

ANSI/NEDA Number	IEC Number	Volts
13A	LR20	1.5D
13AC	LR20	1.5D
13C	R20S	1.5D
13CD	R20S	1.5D
13D	R20C	1.5D
13F	R20S	1.5D
14A	LR14	1.5C
14AC	LR14	1.5C
14C	R14S	1.5C
14CD	R14C	1.5C
14D	R14C	1.5C
14F	R14S	1.5C
15A	LR6	1.5AA
15AC	LR6	1.5AA
15C	R6S	1.5AA
15CD	R6C	1.5AA
15D	R6C	1.5AA
15F	R6S	1.5AA
24A	LR03	1.5AAA
24AC	LR03	1.5AAA
24F	R03	1.5AAA
210	20F20	30.00
215	15F20	22.50
221	15F15	22.50
900	-	1.50
903	-	7.50
904	-	9.00
905	R40	1.50
906	R40	1.50
907	-	6.00
908	-	6.00
908A	-	6.00
908AC	-	6.00
908C	-	6.00
908CD	-	6.00
908D	-	6.00

Specifications:

ANSI/NEDA Number	IEC Number	Volts
910A	LR1	1.5(N)
910M	-	1.40
915	-	6.00
915A	-	6.00
915AC	-	6.00
915C	-	6.00
915D	-	6.00
918	4R25-2	6.00
918A	-	6.00
918AC	-	6.00
918D	4R25-2	6.00
922	-	12.00
926	-	12.00
926AC	-	12.00
1100M	NR50	1.40
1105M	NR52	1.40
1107SOP	SR44	1.50
1109M	MR50	1.35
1110MP	MR50	1.35
1114MP	MR9	1.35
1117M	-	1.35
1118M	-	1.40
1118MD	-	1.40
1604CD	6F22	9.00
1604D	6F22	9.00
1604M	-	8.40
1604MC	-	8.40
1801M	-	11.20
1810M	-	12.60
7000ZD	PR48	1.40
7001ZD	PR43	1.40
7002	PR41	1.40
7003ZD	PR44	1.40
7004Z	-	8.40
7005ZD	PR70	1.40
7007Z	-	1.40

Batteries are listed by their National Electronic Distributors Association (NEDA) battery cross reference guide numbers and letter suffixes. Definitions of the letters are:

A - Alkaline	CS - Industrial Super Heavy Duty	SOP - Silver Oxide Photogenic
AC - Alkaline Industrial	D - Heavy Duty	Z - Zinc Air
AP - Alkaline Photogenic	F - General Purpose	ZD - Zinc Air Heavy Duty
C - Industrial	P - Photogenic	No Suffix - Carbon Zinc
CD - Industrial Heavy Duty	SO - Silver Oxide	



A l l t h e p o w e r y o u ' l l e v e r n e e d



Panasonic Industrial Company Division of Matsushita Electric Corporation of America

Panasonic Industrial Alkaline and Specialty Products Group

Northeast / Headquarters Two Panasonic Way Secaucus, NJ 07094 201-271-3356 Fax: 201-392-6361

Midwest Office 1707 N. Randall Road Elgin, IL 60123 847-468-5707

Southeast Office 1225 Northbrook Pkwy. Suite #1-150 Suwanee, GA 30174 770-338-6926

Southwest Office 8105 N. Beltline Road Suite #100 Irving, TX 75063 972-915-1245

West Office 6550 Katella Avenue Cypress, CA 90630 714-373-7143

Distributed by Panasonic Industrial Co.
Secaucus, NJ 07094 Made in U.S.A.