

75600B0128

DWG. NO.

75600-B-0128

SHT.

REV.

REVISIONS		DATE	APPROVED
ZONE	REV.	DESCRIPTION	

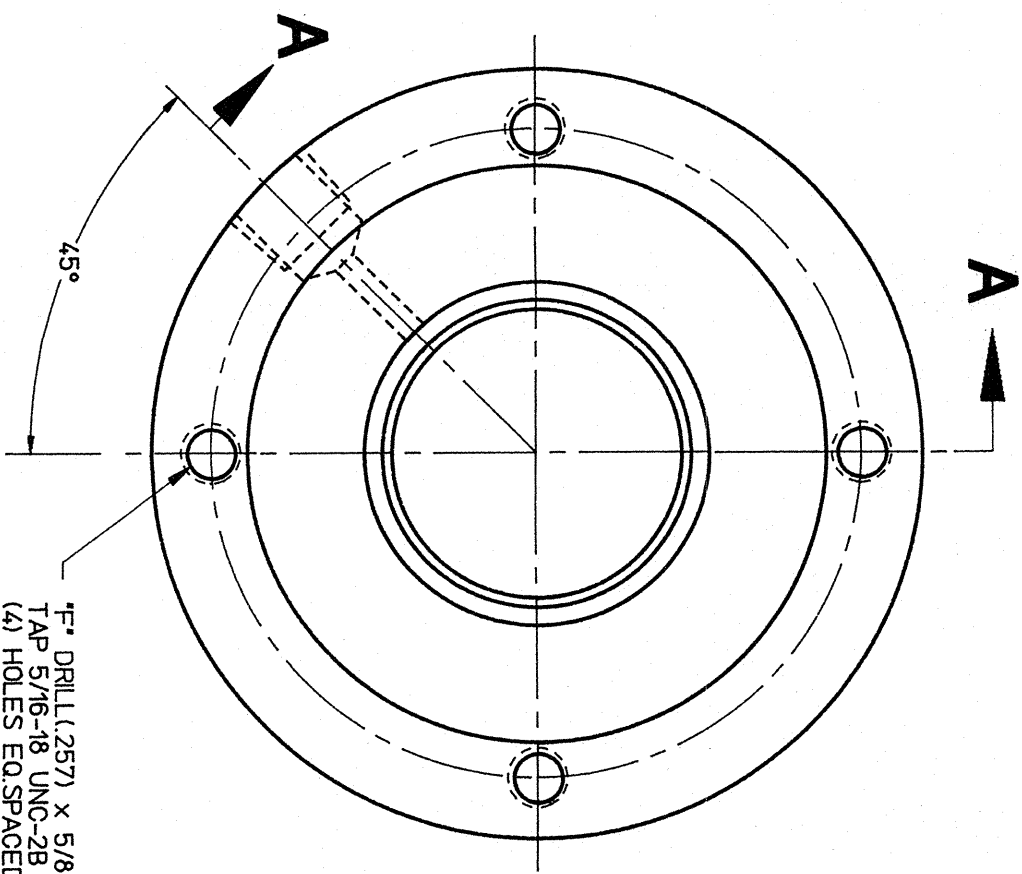

1/8" DRILL(.257) x 5/8" DP.
TAP 5/16-18 UNC-2B x 1/2" DP.
(4) HOLES EQ.SPACED ON
3.372/3.375 DIA. B.C.

⊕ A B .005

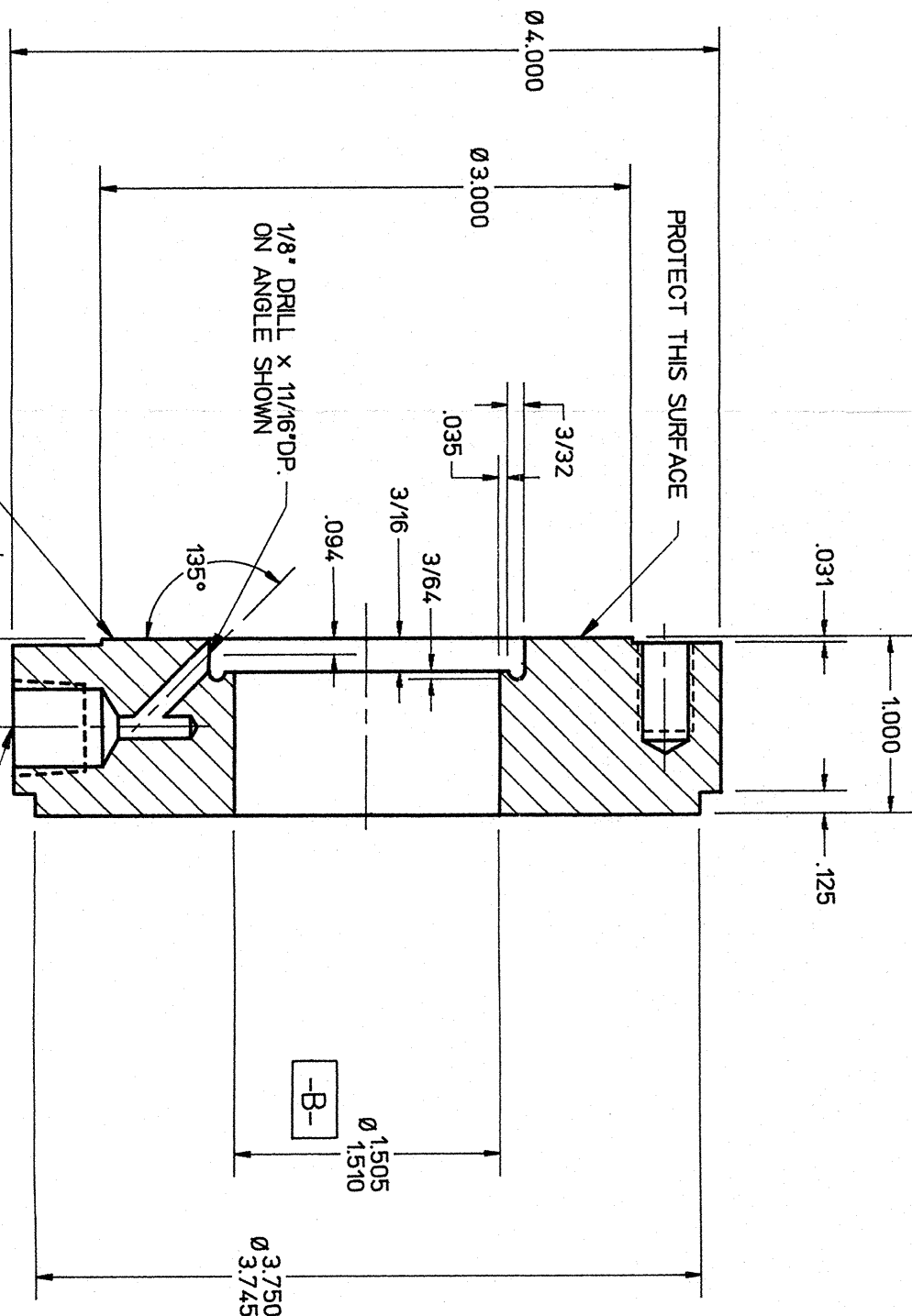

SECTION A-A

1/8" DRILL x 1" DEEP
C-BORE 7/16" TAP DRILL x 1/2" DP.
TAP 1/4" NPT
(1) HOLE LOCATION AS SHOWN

∇.002
-A-

DIM & TOL PER ANSI Y14.5
UNLESS OTHERWISE SPECIFIED
DIMENSIONS ARE IN INCHES
TOLERANCES ARE:
FRACTIONS DECIMAL ANGLES
± 1/64 XXX ± .005 ± 1°

MATERIAL
St. Sl. Type 304

FINISH 125 UNLESS OTHERWISE NOTED
DEBURR & BREAK ALL SHARP EDGES

DO NOT SCALE DRAWING

CADD I.D. NO.

APPROVALS

DRAWN M. Zarecky

CHECKED R. Brown

APPROVED/ORIGINATOR

APPROVED

DATE

3/9/89

4/12/89

4/12/89

4/12/89

GEBAF
The Continuous Electron Beam Accelerator Facility
NEWPORT NEWS, VIRGINIA
UNITED STATES DEPARTMENT OF ENERGY

1-1/2" Valve Flange for 3 1/2"(10) Jacket
w/Port for Relief Line

SIZE DWG. NO.

75600-B-0128

REV.

SCALE Full USED ON ASSY NO. 75300-E-0060 SHEET 1 OF 1