

75600B0179

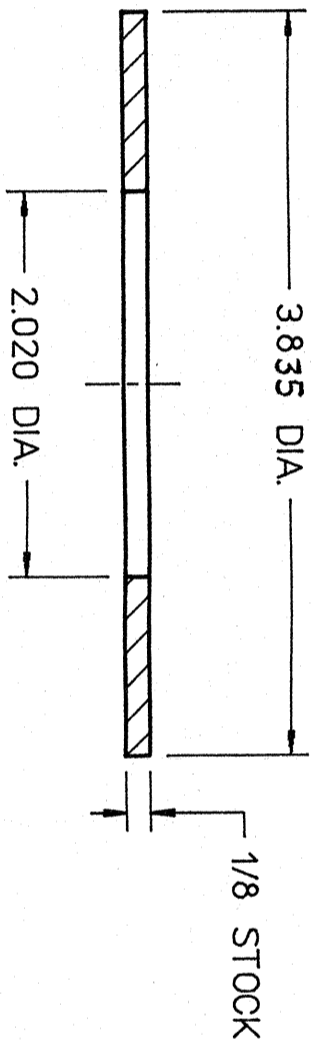
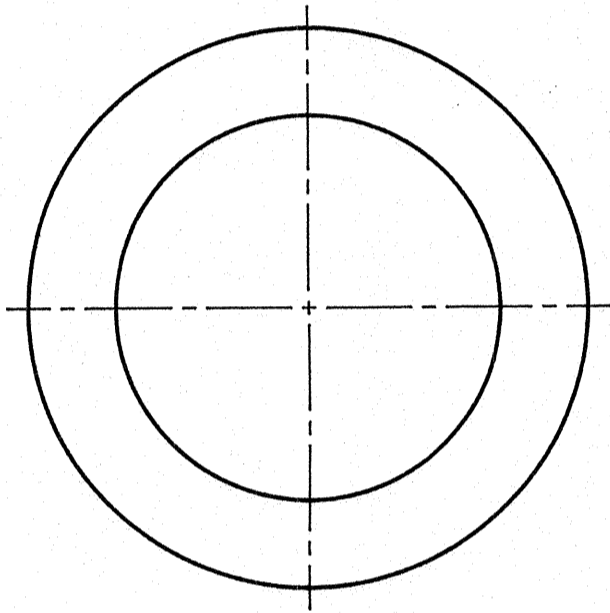

DWG. NO. 75600-B-0179 SHT. REV.

REVISIONS		DATE	APPROVED
ZONE	REV.	DESCRIPTION	

NOTES:

- 1.) PART DESIGNED TO FIT OVER 2" O.D. TUBE & FIT INTO 4" NOM. (4 1/8" O.D. X 134" W.) TYPE K COPPER TUBE

DIM. & TOL. PER ANSI Y14.5 UNLESS OTHERWISE SPECIFIED DIMENSIONS ARE IN INCHES TOLERANCES ARE: FRACTIONS DECIMAL ANGLES ± 1/64 .XX ± °		CADD I.D. NO. [mbs679]mbs_7[mbs_7_575600]B0179		 The Continuous Electron Beam Accelerator Facility NEWPORT NEWS, VIRGINIA UNITED STATES DEPARTMENT OF ENERGY	
MATERIAL COPPER		APPROVALS DRAWN M. ZARECKY	DATE 1/11/90	HEAT INTERCEPT RING, 2" BAYONET	
FINISH ✓ UNLESS OTHERWISE NOTED DEBURR & BREAK ALL SHARP EDGES		CHECKED [Signature]	1/31/90	SIZE DWG. NO. B 75600-B-0179	
DO NOT SCALE DRAWING		APPROVED [Signature]	1/31/90	SCALE 2:1	USED ON ASSY NO. 75300-E-0028 SHEET 1 OF 1