

75600B0185

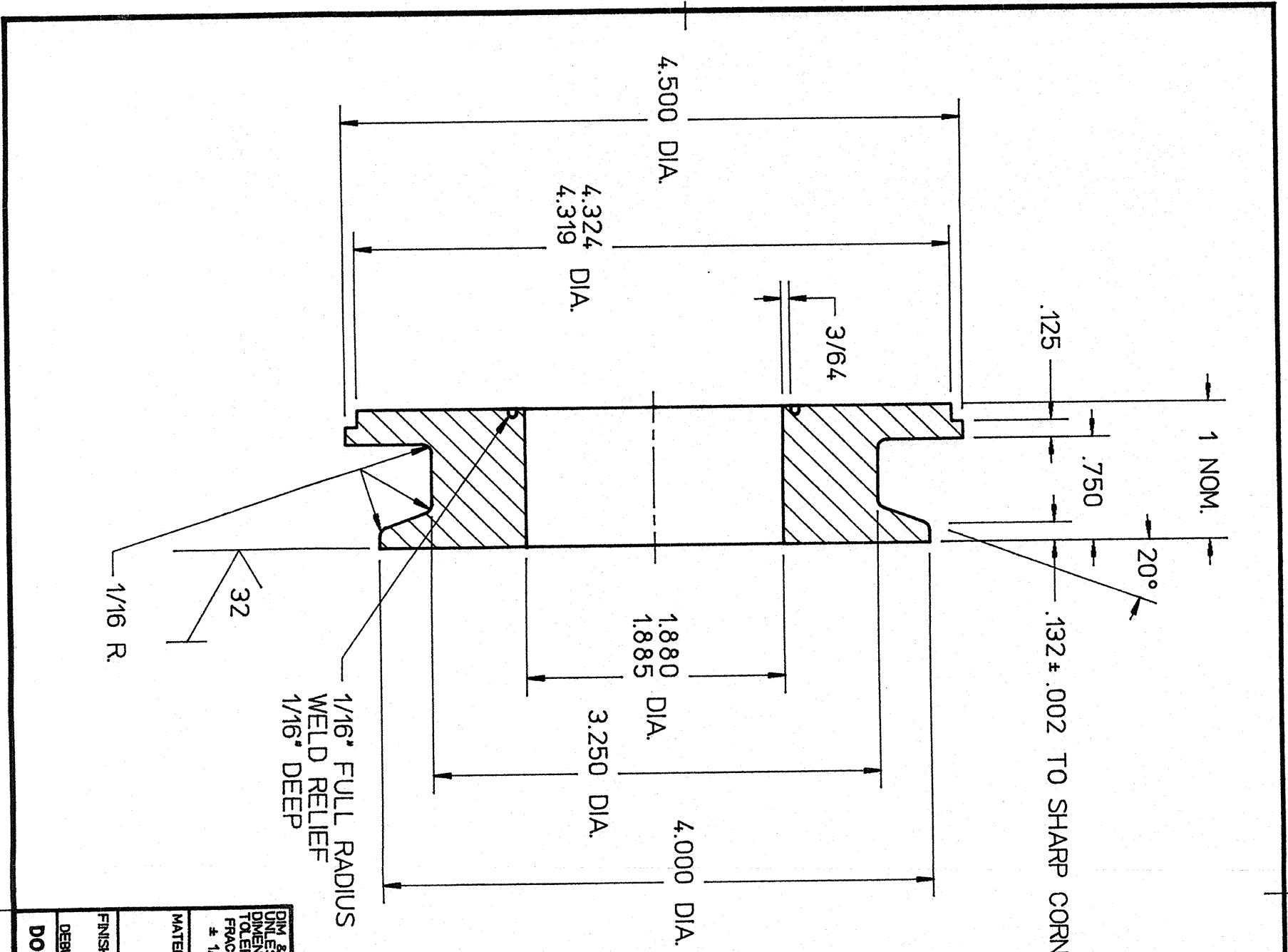

DWG. NO. 75600-B-0185

SHT. REV.

REVISIONS		DATE	APPROVED
ZONE	REV.	DESCRIPTION	

DIM & TOL. PER ANSI Y14.5
UNLESS OTHERWISE SPECIFIED
DIMENSIONS ARE IN INCHES
TOLERANCES ARE:
FRACTIONS DECIMAL ANGLES
± 1/64 .XXX ± .005 ± 1°

CADD I.D. NO.
[mbs679]wbs_7[mbs_7_575600]B0185

APPROVALS	DATE
DRAWN M. ZARECKY	12/18/89
CHECKED DPC	1/31/90
APPROVED/ORIGINATOR DPC	1/31/90
APPROVED DPC	1/31/90

GERBAP
The Continuous Electron Beam Accelerator Facility
NEWPORT NEWS, VIRGINIA
UNITED STATES DEPARTMENT OF ENERGY

MATERIAL
ST. STL. TYPE 304

FINISH
125

UNLESS OTHERWISE NOTED
DEBURR & BREAK ALL SHARP EDGES

U-TUBE FLANGE, 2" MALE BAYONET
(4" IPS SCH-5 JACKET)

DO NOT SCALE DRAWING

SIZE DWG. NO.
B 75600-B-0185

SCALE FULL

USED ON ASSY NO. 75300-E-0029

SHEET / OF /