

TOP VIEW 1-6C

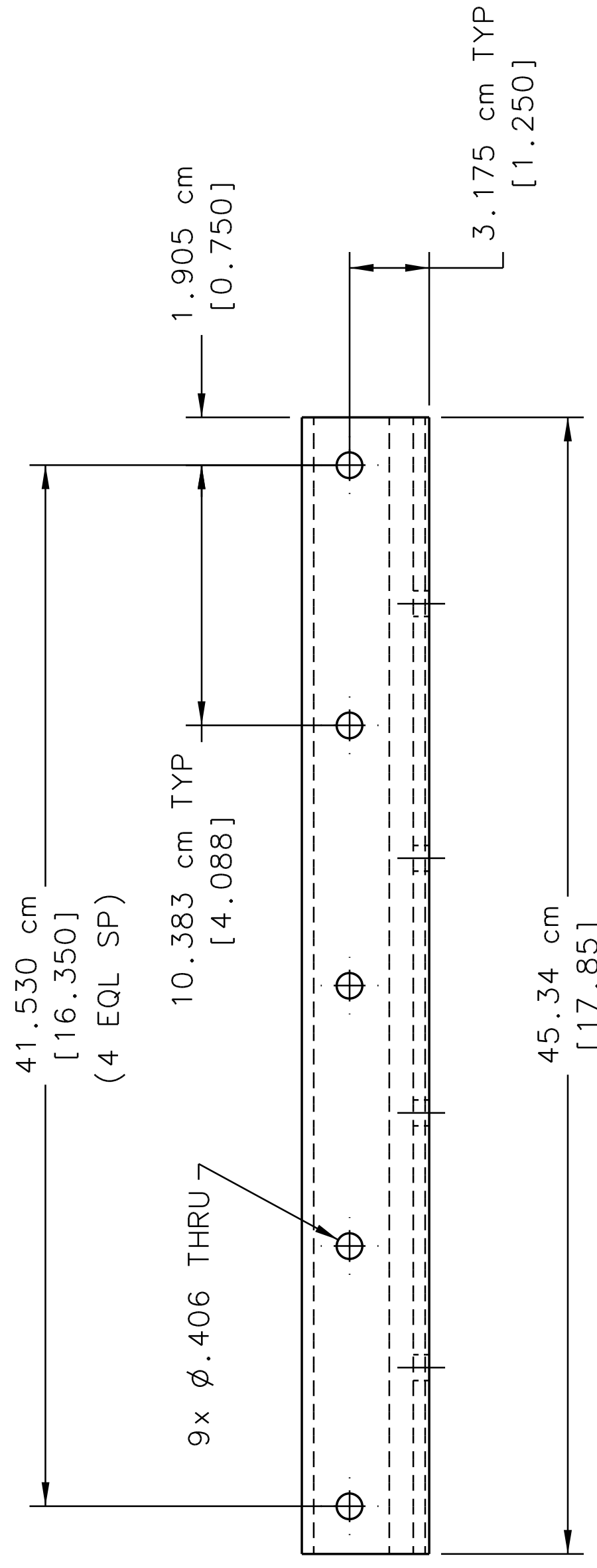

FRONT VIEW 1-6B

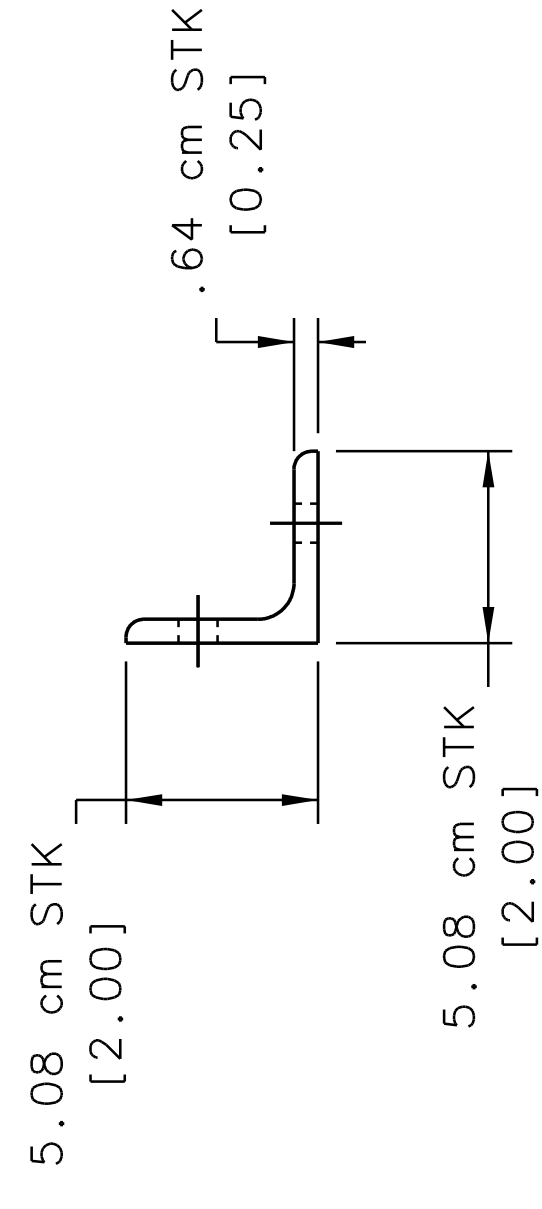

RS VIEW 1-4B

NOTES:

1. WEIGHT IS APPROXIMATELY 5 LBS.
2. PART TO BE CONDITIONED FOR SAFE HANDLING. REMOVE ALL BURRS AND SHARP EDGES.
3. ALL SURFACES SHALL BE PRIMED WITH ONE 2.0 MIL COAT OF RUSTOLEAN #1573 OR EQUIVALENT. SURFACES SHALL BE PAINTED WITH ONE ADDITIONAL INTERMEDIATE 1.5 COAT OF RUSTOLEUM #2766. APPLY A FINISH COAT OF STD WHITE FULL GLOSS ALKYD PAINT OR EQUIVALENT.

ZONE	REV	DESCRIPTION	DATE	APPROVED

DOCUMENT CONTROL STAMP	UNLESS OTHERWISE SPECIFIED, DIMENSIONS ARE IN INCHES FRACTIONS DECIMAL X.XX ± .01 .XXX ± .005 ± N/A	TRACKING NO. I/A	DATE	United States Department of Energy
				Jefferson Lab Thomas Jefferson National Accelerator Facility
MATERIAL	THIRD ANGLE PROJECTION	APPROVALS		HALL A - GENL EQUIPMENT
A36 STEEL	UNLESS OTHERWISE NOTED DEBURR & BREAK ALL SHARP EDGES	DRAWN	25 NOV 13	GRINCH DETECTOR ASSY
2 x 2 x 1/4		CHECKED		PMT ARRAY BOX ASSY
FINISH 125 UNLESS OTHERWISE NOTED	DO NOT SCALE DRAWING	APPROVED		ANGLE HORIZONTAL MOUNT
DEBURR & BREAK ALL SHARP EDGES		APPROVED		SIZE DWG. NO. A00000-01-01-3407
				REV. -
				SCALE 1:2
				1000 DWG NO. A00000-01-01-3400 SHEET 1 OF 1