

Cables inventory

1. HV:

- ▶ HV Flat cables (in progress): M. Crouau
- ▶ HV Patch panel (in progress): M. Brossard
- ▶ HV red cables: 120 30-m-long cables to be found at JLab
- ▶ HV Power supply (to find at JLab)

2. LV:

- ▶ LV Flat cables (?)
- ▶ LV Patch panel (?)
- ▶ LV Power supply (?)

3. DC:

- ▶ Shield flat cables (?)
- ▶ Patch panel (?)
- ▶ ADC & power supply (?)

4. Signal

- ▶ DVCS stand patch panel (?)
- ▶ HRS hut patch panel (?)

DAQ

- ▶ New linux (and new disks) installed in adaqh1 (Test Lab)
- ▶ CODA 2.5 (almost) working in new Linux
- ▶ Basic CODA configuration (i.e. 1 ROC) working
- ▶ Scripts to address initialization registers of ARS boards
- ▶ Hopefully be able to read ARS events (from a pulser) this week

Calorimeter assembly

- ▶ Calorimeter stand to be delivered early this week
- ▶ All PMTs and brass holders onsite
- ▶ Missing some plastic pieces to assemble the blocks into the brass holder (being shipped today from CF)
- ▶ New blocks (201-300) already wrapped on tyvek
- ▶ Old blocks to be dismantled, cleaned and rewrap

Calorimeter assembly

PHASE 1

Insérer le cristal entre les cliquets
Insert the crystal

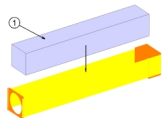

PHASE 2

Insérer la pièce en epoxy
Insert the epoxy piece

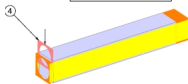

PHASE 3

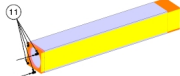

mettre les quatre vis 4-40 UNC et bloquer le cristal
Screw the four 4-40 UNC screws

PHASE 4

mettre la graisse optique
put optic grease



PHASE 7

Vérifier la répartition de la graisse optique sur la fenêtre du PMT
check optic grease distribution on the PMT window



PHASE 5

insérer l'ensemble PMT avec le connecteur parallèle aux cliquets
insert the PMT, set the connector in parallel with brass foil

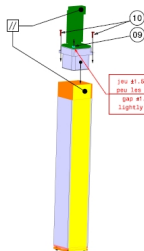

PHASE 6

serrer les deux vis 0-80 UNF puis mettre un jeu minime 0.2 les vis plastiques
Screw the two 0-80 UNF and adjust the plastic screw with a small gap 0.2 white PCB



PHASE 8

ensemble prêt à emballer avec le "TYVEK"
ready to put "TYVEK"

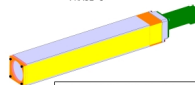

11	4	vis 4-40 UNC 3/16			
10	2	vis 0-80 UNF 1/4			
09	2	vis Cs M2x6	plastic M2x6 slotted cheese head screw		
08	1	PMT		HAMAMATSU	
07	1	Bride isolante	DVCS2_CALD-D107C		
06	1

A	G Reimhuth	09/04/2016	Pour assemblage
Ind.	validé par	Date	Commentaires
LPC LABORATOIRE DE PHYSIQUE CORPUSCULAIRE IN2P3/CNRS - Université Blaise Pascal 63177 Aubière Cedex			
			Fax : 04 70 80 51 48 http://lpcwww.in2p3.fr

Plan for the week

- ▶ Continue calorimeter block wrapping
- ▶ DAQ/Offline software development