

Muon detector

- grey = iron absorber
 - between 30 and 90 cm
- Yellow & Red = muon detector
 - $4.87 \times 2.42 \times 0.45 \text{ m}^3$

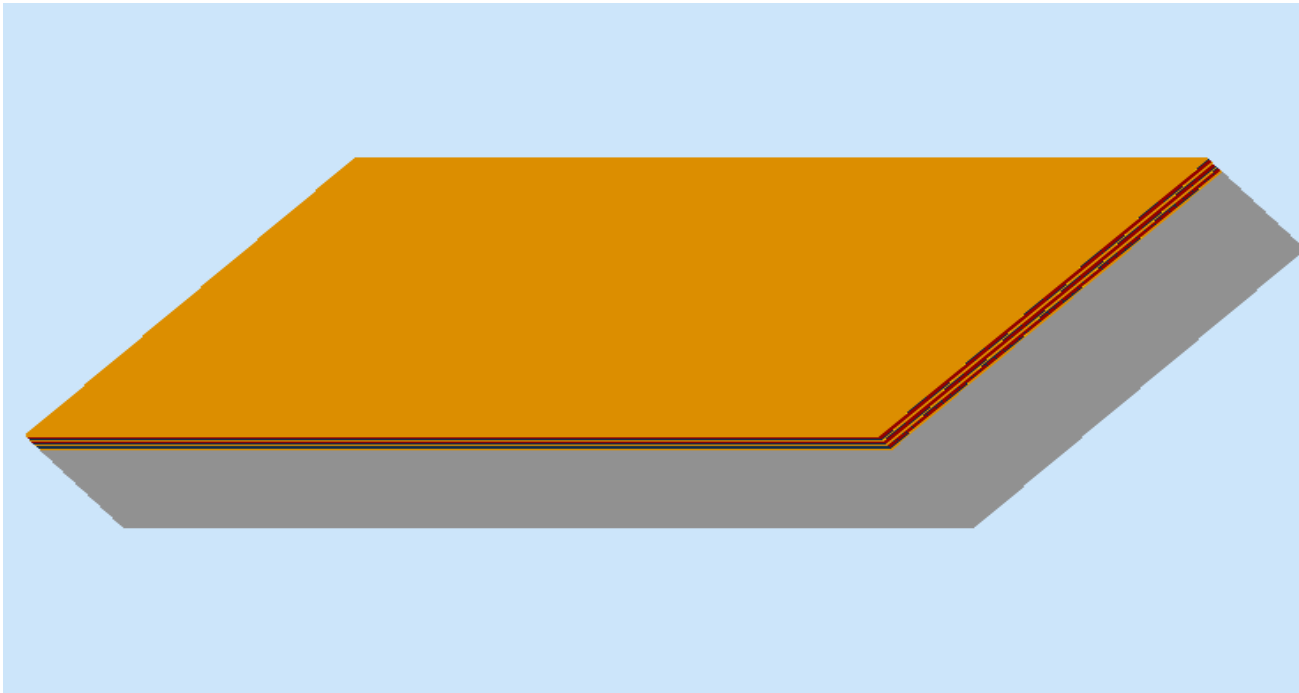

Muon detector

- Red = Argon/ethane wire chamber
- blue = PVC comb
- gold = foam separator

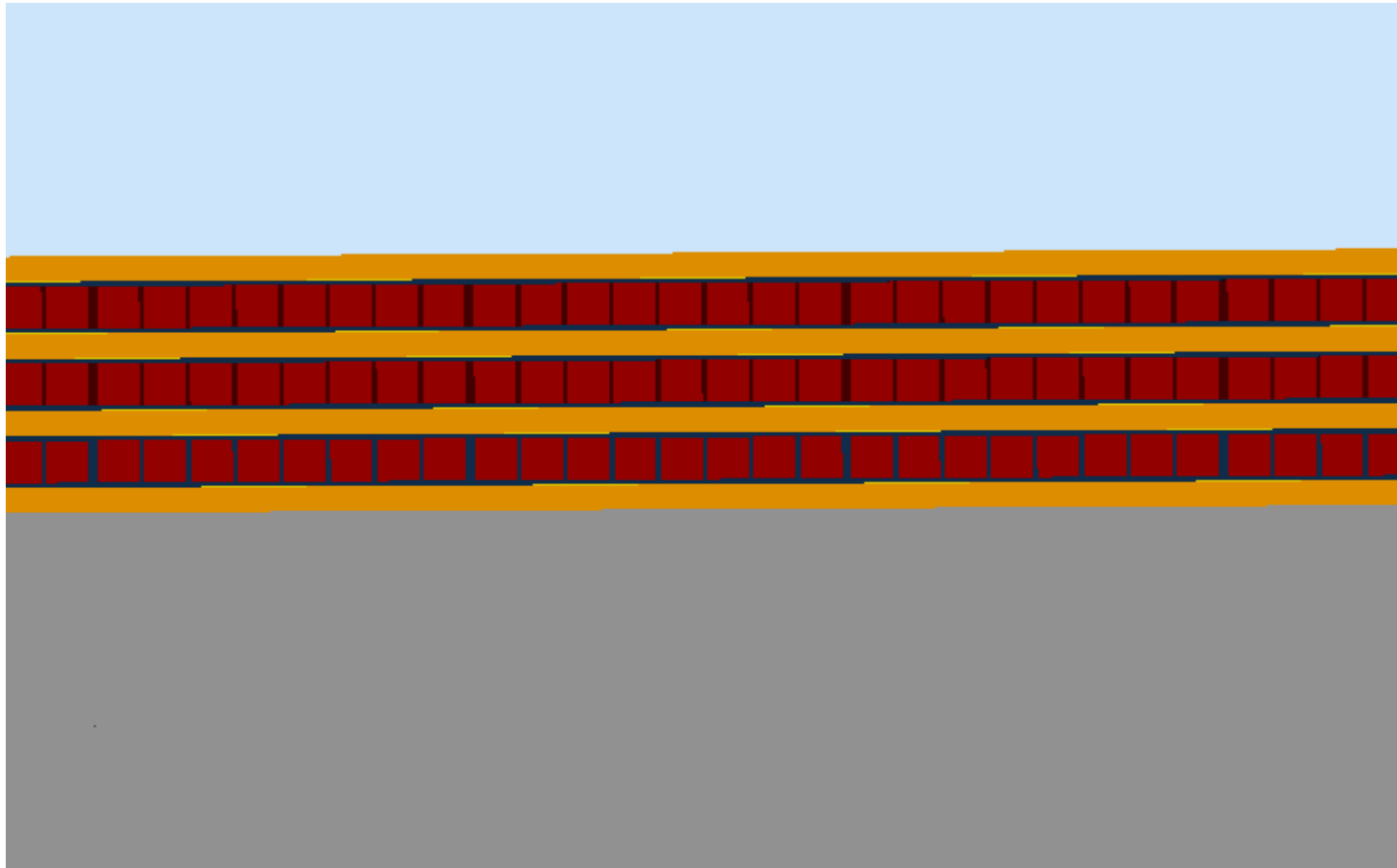

Muon detector in SoLID

- Actual detector will contain three layers of iron/detector

